

SCHEDULE 1

HARRIOTT @ ARMSTRONG CREEK STAGE 13 BUILDING ENVELOPES

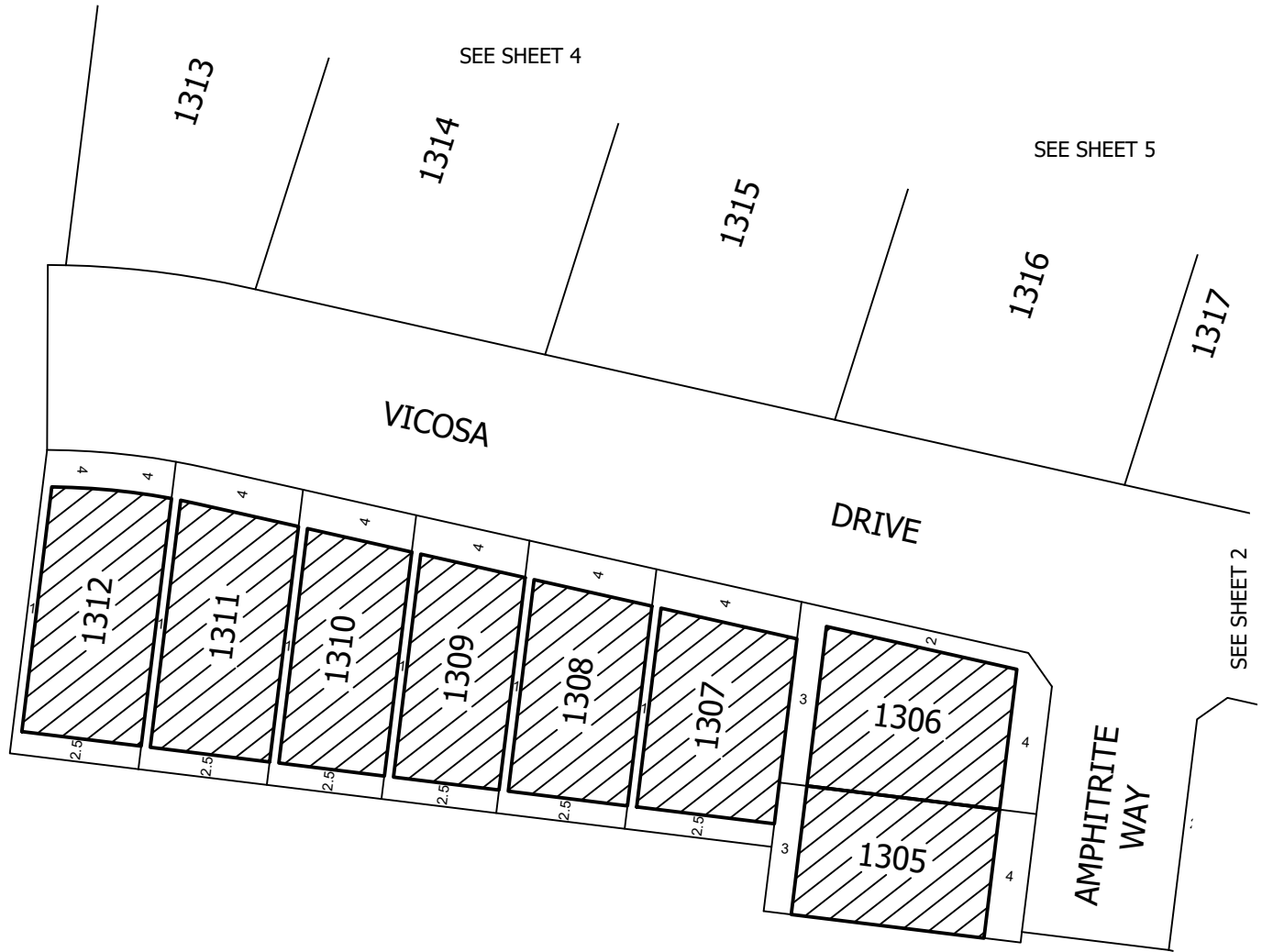

- BUILDING ENVELOPE

- Garages are to be set back a minimum of 5 metres from the primary frontage of the allotment and 0.50 metres behind the front of the dwelling
- Balconies, verandas, open porches, covered walkways and porticos that have a maximum height less than 4.50 metres above the ground level may encroach into the front setback by 1.50 metres.
- Facade treatments and /or covered balconies or verandas on the second storey of a building that have a maximum height of less than 6.60 metres above ground level may encroach into the front setback by 1.50 metres.
- Porches, verandas, eaves, fascia, gutters and screens may encroach into the side and rear setback by 0.50 metres
- Domestic fuel tanks and water tanks may encroach into the side and rear setback by 0.50 metres
- Heating and cooling equipment and other services may encroach into the side and rear setback by 0.50 metres



MC MULLEN NOLAN GROUP
Level 1 / 5 Queens Road
Melbourne VIC 3004
Tel: (03) 7002 2200
Fax: (03) 7002 2299
Email: info@mngsurvey.com.au
www.mngsurvey.com.au
MNG Ref : 80004be-099c

SCALE
1:750

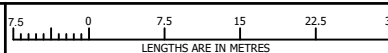

ORIGINAL SHEET
SIZE: A4

SHEET 1 OF 6

VERSION C

HARRIOTT
AT ARMSTRONG CREEK

SCHEDULE 1

HARRIOTT @ ARMSTRONG CREEK STAGE 13 BUILDING ENVELOPES

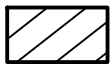
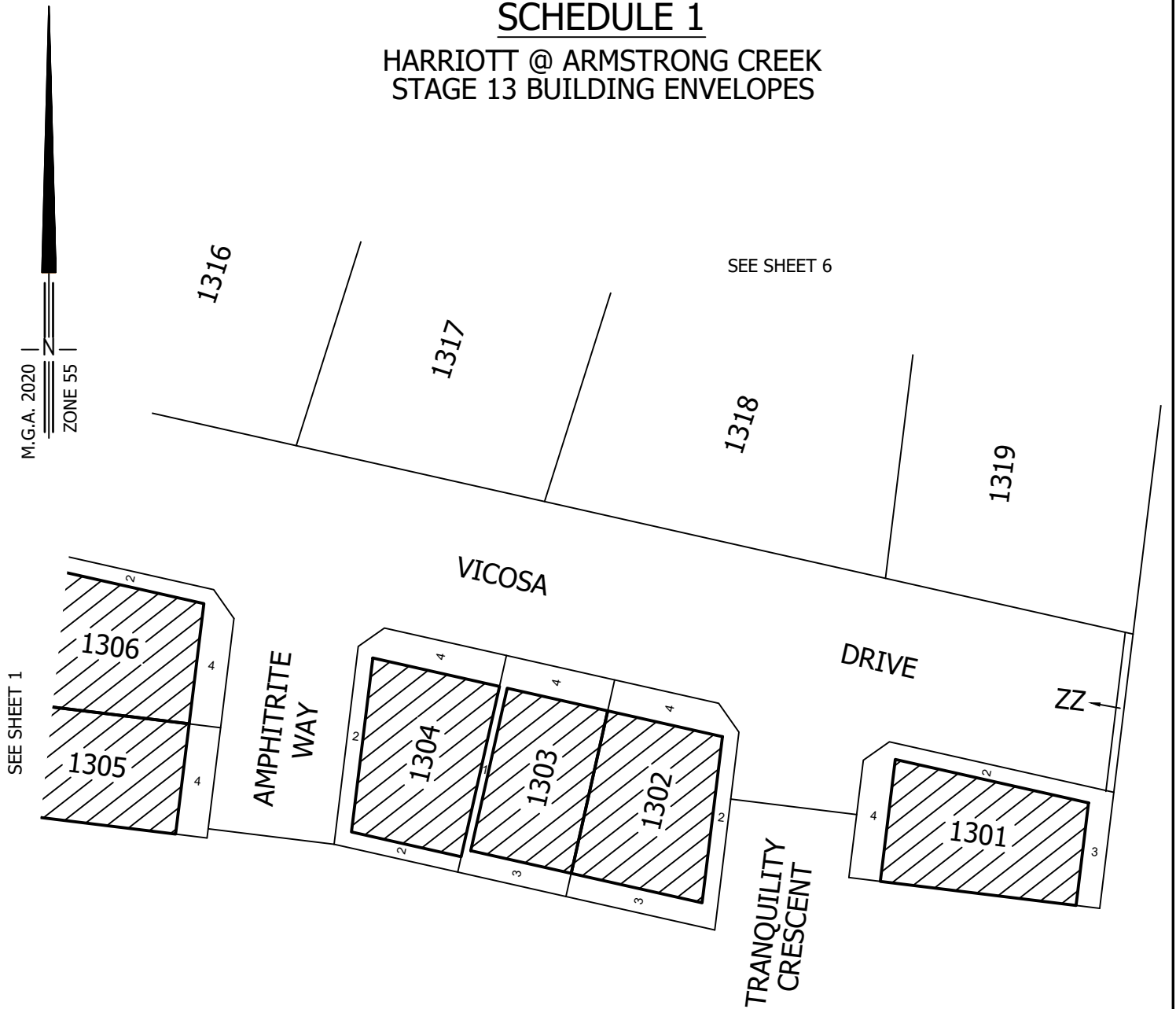

- BUILDING ENVELOPE

- Garages are to be set back a minimum of 5 metres from the primary frontage of the allotment and 0.50 metres behind the front of the dwelling
- Balconies, verandas, open porches, covered walkways and porticos that have a maximum height less than 4.50 metres above the ground level may encroach into the front setback by 1.50 metres.
- Facade treatments and /or covered balconies or verandas on the second storey of a building that have a maximum height of less than 6.60 metres above ground level may encroach into the front setback by 1.50 metres.
- Porches, verandas, eaves, fascia, gutters and screens may encroach into the side and rear setback by 0.50 metres
- Domestic fuel tanks and water tanks may encroach into the side and rear setback by 0.50 metres
- Heating and cooling equipment and other services may encroach into the side and rear setback by 0.50 metres



MC MULLEN NOLAN GROUP
Level 1 / 5 Queens Road
Melbourne VIC 3004
Tel: (03) 7002 2200
Fax: (08) 7002 2299
Email: info@mngsurvey.com.au
www.mngsurvey.com.au
MNG Ref : 80004be-099c

SCALE
1:750

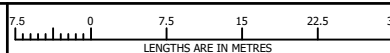

ORIGINAL SHEET
SIZE: A4

SHEET 2

VERSION C

HARRIOTT
AT ARMSTRONG CREEK

SCHEDULE 1

HARRIOTT @ ARMSTRONG CREEK STAGE 13 BUILDING ENVELOPES

M.G.A. 2020 |
ZONE 55 |

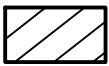
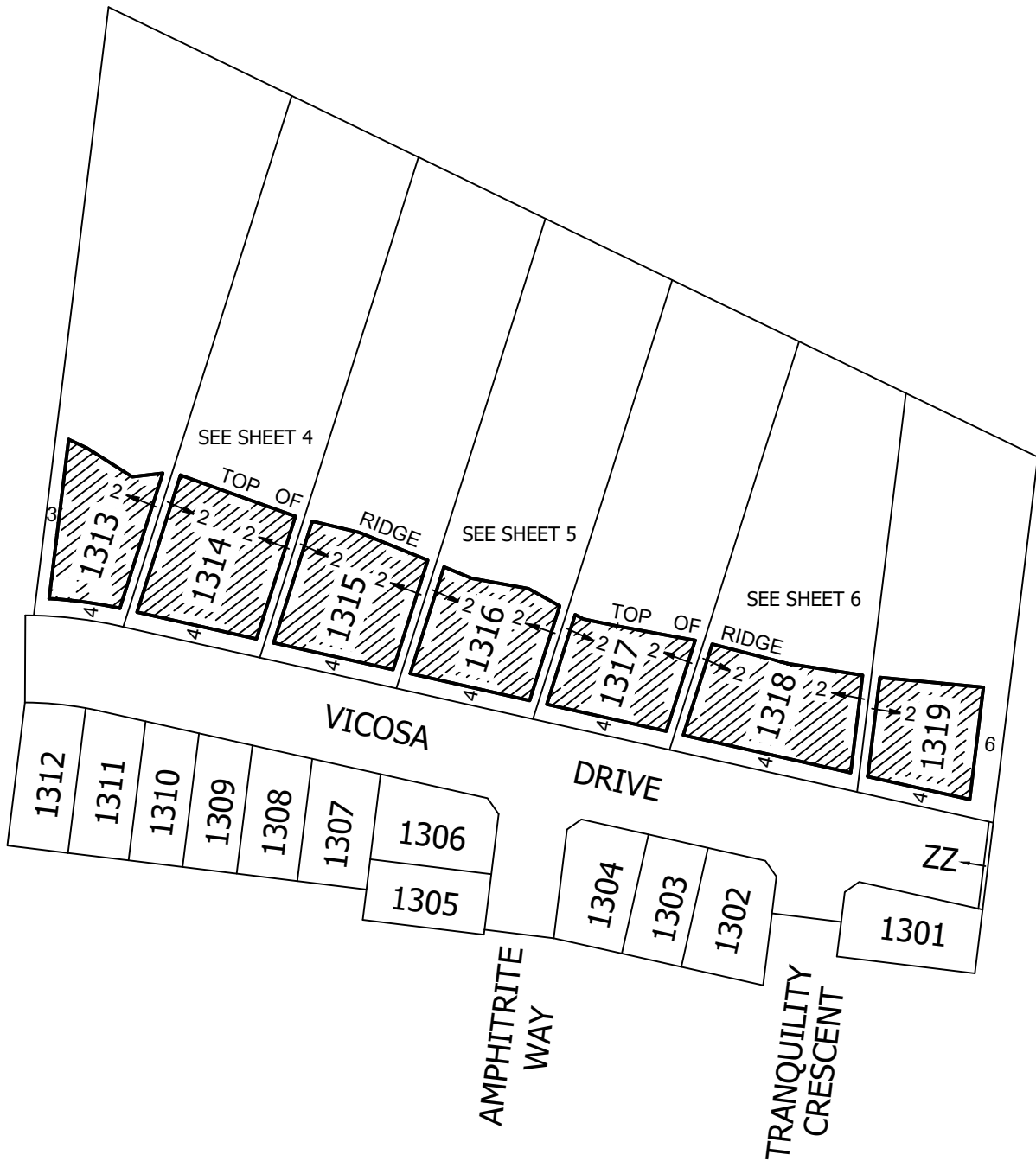

- BUILDING ENVELOPE

- Garages are to be set back a minimum of 5 metres from the primary frontage of the allotment and 0.50 metres behind the front of the dwelling
- Balconies, verandas, open porches, covered walkways and porticos that have a maximum height less than 4.50 metres above the ground level may encroach into the front setback by 1.50 metres.
- Facade treatments and /or covered balconies or verandas on the second storey of a building that have a maximum height of less than 6.60 metres above ground level may encroach into the front setback by 1.50 metres.
- Porches, verandas, eaves, fascia, gutters and screens may encroach into the side and rear setback by 0.50 metres
- Domestic fuel tanks and water tanks may encroach into the side and rear setback by 0.50 metres
- Heating and cooling equipment and other services may encroach into the side and rear setback by 0.50 metres

SCALE
1:1500

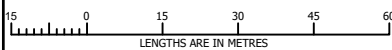

ORIGINAL SHEET
SIZE: A4

SHEET 3



MC MULLEN NOLAN GROUP
Level 1 / 5 Queens Road
Melbourne VIC 3004
Tel: (03) 7002 2200
Fax: (03) 7002 2299
Email: info@mngsurvey.com.au
www.mngsurvey.com.au
MNG Ref : 80004be-099c

VERSION C

HARRIOTT
AT ARMSTRONG CREEK

SCHEDULE 1

HARRIOTT @ ARMSTRONG CREEK STAGE 13 BUILDING ENVELOPES

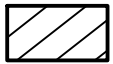
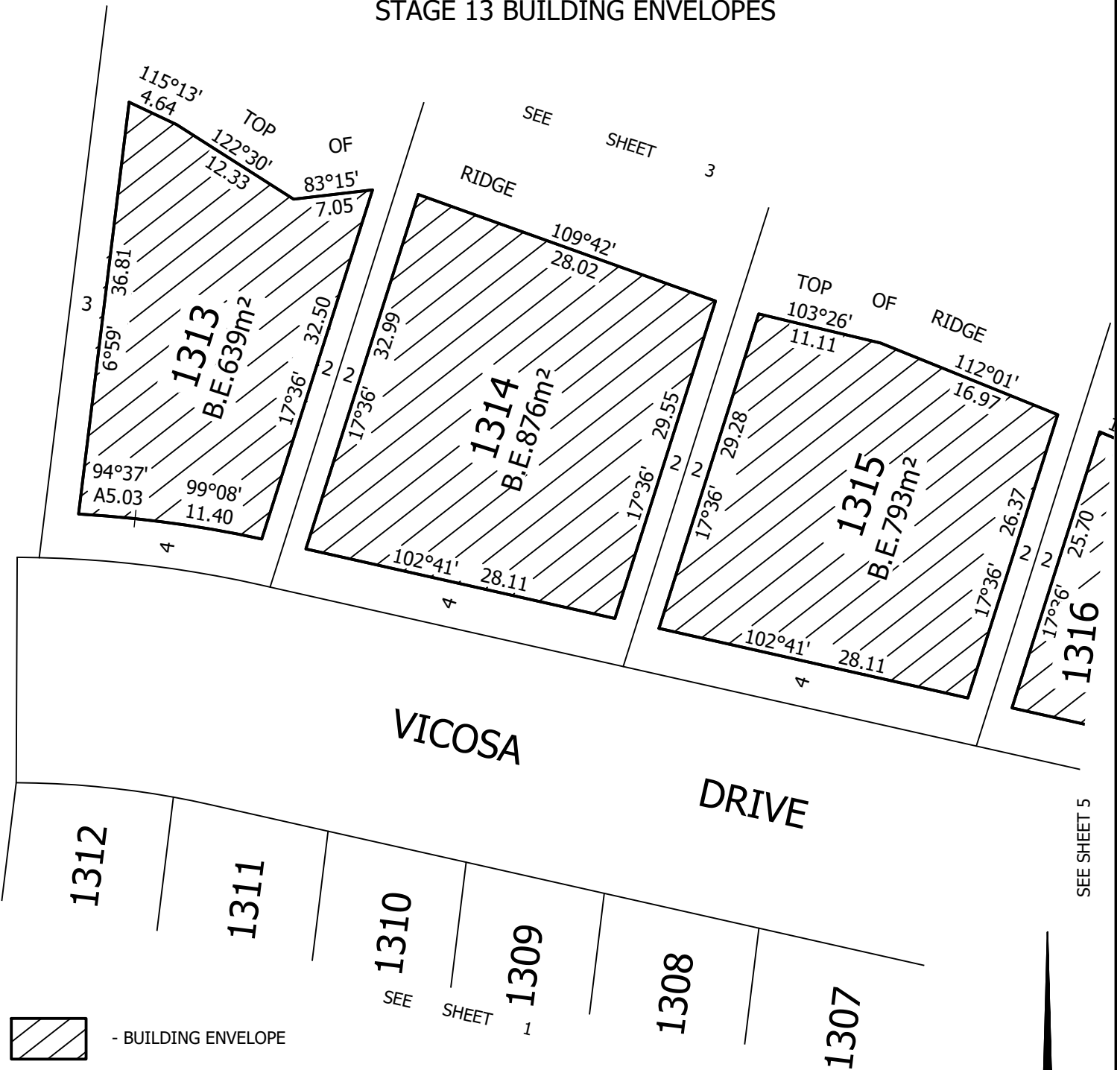

- BUILDING ENVELOPE

B.E.Xm² - DENOTES AREA OF BUILDING ENVELOPE

- Garages are to be set back a minimum of 5 metres from the primary frontage of the allotment and 0.50 metres behind the front of the dwelling
- Balconies, verandas, open porches, covered walkways and porticos that have a maximum height less than 4.50 metres above the ground level may encroach into the front setback by 1.50 metres.
- Facade treatments and /or covered balconies or verandas on the second storey of a building that have a maximum height of less than 6.60 metres above ground level may encroach into the front setback by 1.50 metres.
- Porches, verandas, eaves, fascia, gutters and screens may encroach into the side and rear setback by 0.50 metres
- Domestic fuel tanks and water tanks may encroach into the side and rear setback by 0.50 metres
- Heating and cooling equipment and other services may encroach into the side and rear setback by 0.50 metres

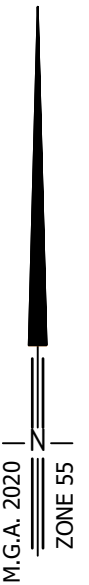

MC MULLEN NOLAN GROUP
Level 1 / 5 Queens Road
Melbourne VIC 3004
Tel: (03) 7002 2200
Fax: (03) 7002 2299
Email: info@mngsurvey.com.au
www.mngsurvey.com.au
MNG Ref : 80004be-099c

SCALE
1:500

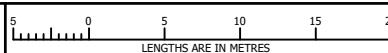

ORIGINAL SHEET
SIZE: A4

SHEET 4

VERSION C



SCHEDULE 1

HARRIOTT @ ARMSTRONG CREEK STAGE 13 BUILDING ENVELOPES

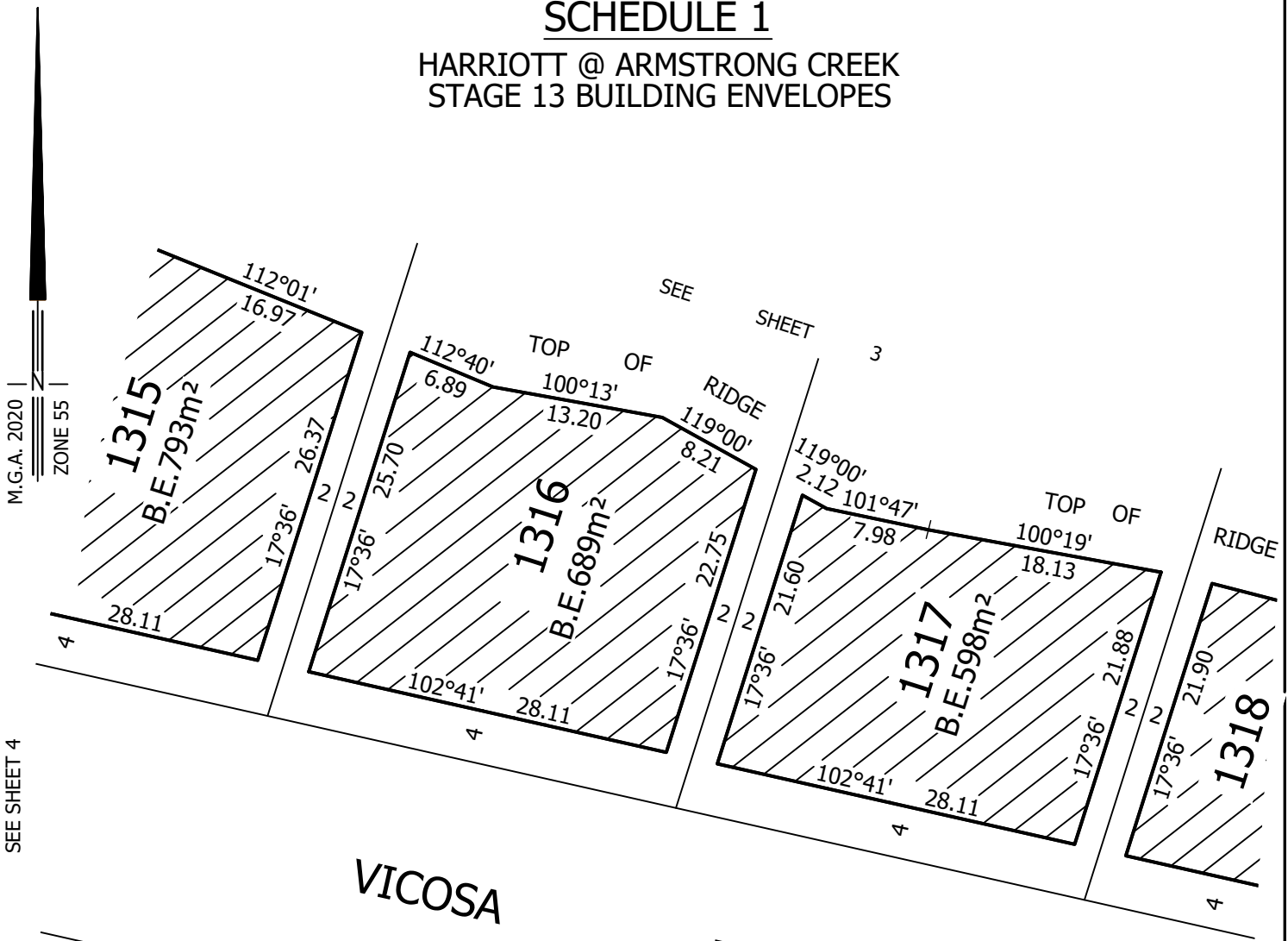

SEE SHEET 4

SEE SHEET 3

SEE SHEET 6

VICOSA

DRIVE

AMPHITRITE
WAY

1307

1306

1304

1303

1302

SEE SHEET 1

SEE SHEET 2

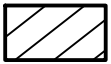

- BUILDING ENVELOPE

B.E.Xm² - DENOTES AREA OF BUILDING ENVELOPE

- Garages are to be set back a minimum of 5 metres from the primary frontage of the allotment and 0.50 metres behind the front of the dwelling
- Balconies, verandas, open porches, covered walkways and porticos that have a maximum height less than 4.50 metres above the ground level may encroach into the front setback by 1.50 metres.
- Facade treatments and /or covered balconies or verandas on the second storey of a building that have a maximum height of less than 6.60 metres above ground level may encroach into the front setback by 1.50 metres.
- Porches, verandas, eaves, fascia, gutters and screens may encroach into the side and rear setback by 0.50 metres
- Domestic fuel tanks and water tanks may encroach into the side and rear setback by 0.50 metres
- Heating and cooling equipment and other services may encroach into the side and rear setback by 0.50 metres



MC MULLEN NOLAN GROUP
Level 1 / 5 Queens Road
Melbourne VIC 3004
Tel: (03) 7002 2200
Fax: (03) 7002 2299
Email: info@mngsurvey.com.au
www.mngsurvey.com.au
MNG Ref : 80004be-099c

SCALE
1:500

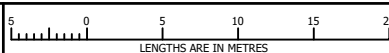

ORIGINAL SHEET
SIZE: A4

SHEET 5

VERSION C

HARRIOTT
AT ARMSTRONG CREEK

SCHEDULE 1

HARRIOTT @ ARMSTRONG CREEK STAGE 13 BUILDING ENVELOPES

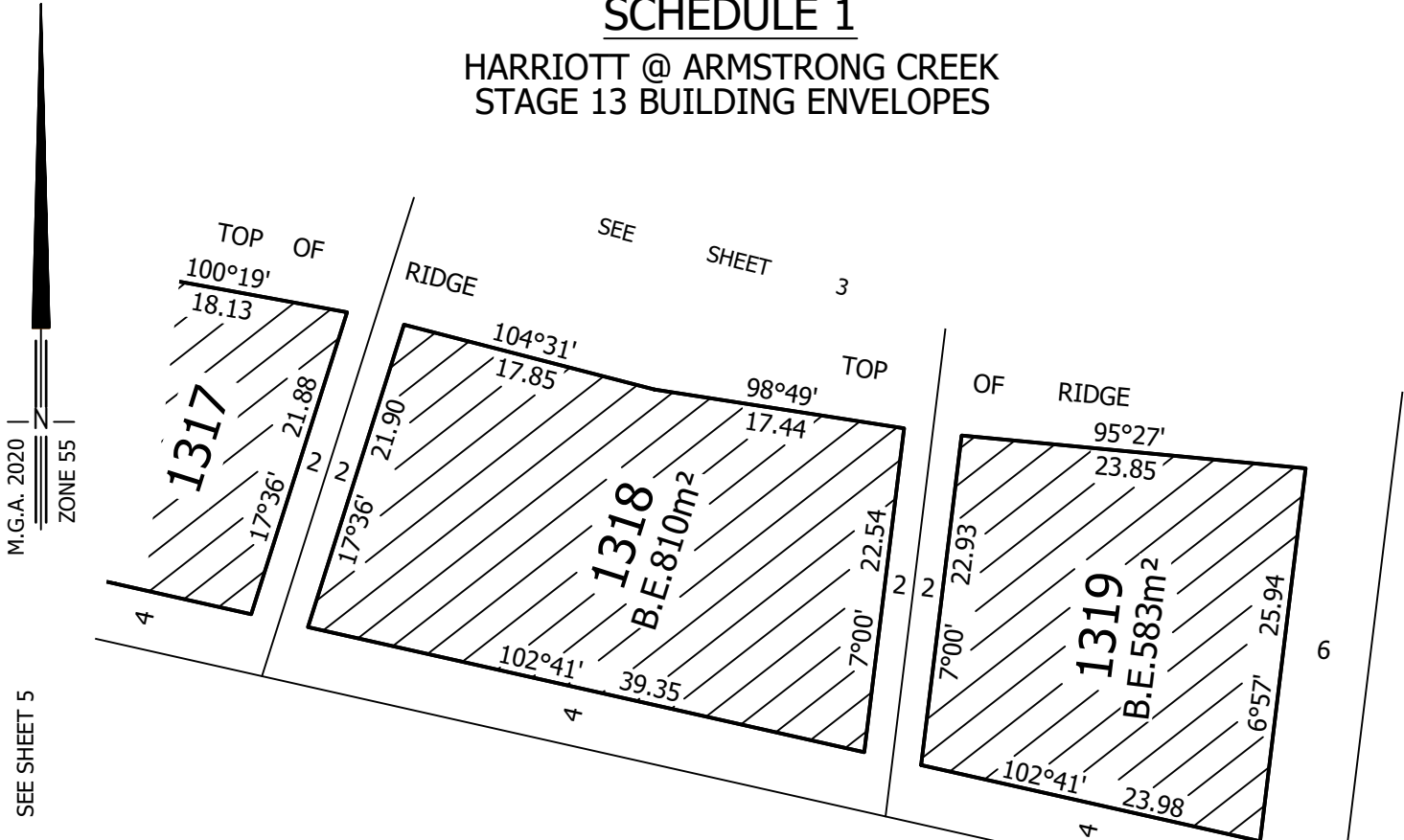

M.G.A. 2020 |
ZONE 55

SEE SHEET 5

SEE SHEET 3

SEE SHEET 2

VICOSA

DRIVE

ZZ

1304

1303

1302

TRANQUILITY
CRESCENT

1301

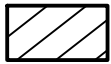

- BUILDING ENVELOPE

B.E.Xm² - DENOTES AREA OF BUILDING ENVELOPE

- Garages are to be set back a minimum of 5 metres from the primary frontage of the allotment and 0.50 metres behind the front of the dwelling
- Balconies, verandas, open porches, covered walkways and porticos that have a maximum height less than 4.50 metres above the ground level may encroach into the front setback by 1.50 metres.
- Facade treatments and /or covered balconies or verandas on the second storey of a building that have a maximum height of less than 6.60 metres above ground level may encroach into the front setback by 1.50 metres.
- Porches, verandas, eaves, fascia, gutters and screens may encroach into the side and rear setback by 0.50 metres
- Domestic fuel tanks and water tanks may encroach into the side and rear setback by 0.50 metres
- Heating and cooling equipment and other services may encroach into the side and rear setback by 0.50 metres

SCALE
1:500

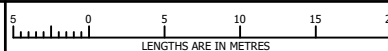

ORIGINAL SHEET
SIZE: A4

SHEET 6



MC MULLEN NOLAN GROUP
Level 1 / 5 Queens Road
Melbourne VIC 3004
Tel: (03) 7002 2200
Fax: (03) 7002 2299
Email: info@mngsurvey.com.au
www.mngsurvey.com.au
MNG Ref : 80004be-099c

VERSION C

