

# Harriott at Armstrong Creek

## Stage 7



### GENERAL NOTES

- The works shall be constructed in accordance with the current Infrastructure Design Manual (IDM) and the City of Greater Geelong requirements. Works to be carried out to the satisfaction of Council's supervising officer.
- The contractor is responsible for safety of work on site in accordance with appropriate legislation. The contractor shall ensure that the site is maintained in a safe manner at all times.
- The contractor shall:
  - Comply with the requirements of the Occupational Health and Safety Act 2007.
  - Notify Workcover of their intention to commence trenching operations where trenches are 1.5 metres or deeper.
  - Ensure that the mine manager or his deputy as required by the Act is in attendance when trenching operations are in progress.
- The contractor is to notify council and all service authorities seven (7) days prior to commencement of construction.
- The location of existing services should be determined by the contractor prior to commencing any excavation by contacting all relevant service authorities. Any existing services shown on the drawings are offered as a guide only and are not guaranteed as correct.
- Removal or retention of existing trees or vegetation must be in accordance with the approved tree removal plan.
- No surplus trees, vegetation or other materials are to be burnt on site.
- All road chainages are measured along the road centreline except kerb returns and courtheads, where lip of kerb chainages are specified. All dimensions and radii are given to the lip of kerb. Do not scale off these drawings, written dimensions only shall be used.
- All levels are to Australian Height Datum (AHD). All coordinates are to Map Grid of Australia (MGA).
- Any existing pavement or drainage works damaged during construction or the maintenance period to be reinstated to the satisfaction of the Council.
- Upon the completion of construction, the whole site shall be cleaned up and graded over. All rubbish is to be removed and the site is to be left in a clean and tidy condition to the satisfaction of the superintendent.

### EARTHWORKS NOTES

- A site environmental management plan is to be approved by Council prior to works commencing. The requirements of the plan are to be maintained onsite for the duration of the works.
- Filling in all properties & road reserves is to be carried out using approved clay fill. Topsoil & all vegetable matter to be stripped from site prior to filling. All filling to be carried out in 150mm layers and compacted to 95% of max. dry density. All filling to comply with AS 3798-2007, Section 8.2, Level 1. A fill report must be submitted from NATA registered soil testing laboratory.
- The nature strips and cut or filled areas are to be topsoiled with a minimum of 100mm of approved material. If the existing topsoil is unsuitable then approved topsoil shall be imported at the contractor's expense.
- Batters into allotments shall not be steeper than 1 in 6 unless shown otherwise.
- Blocks shall be graded to ensure a minimum grade of 1 in 200 to the point of drainage, unless shown otherwise.
- No topsoil to be removed from site without the approval of council.
- If any existing substandard filling is encountered on the site it must be removed and replaced with approved fill material properly compacted to Council requirements. A geo-technical report must be submitted showing details of depth, type of material and density of the fill areas concerned.
- Invert levels must be taken prior to filling of any existing dams or channels and levels provided to the superintendent.

### PAVEMENT NOTES

- Where pavement excavation is in rock, all loose material (including rocks and clay) are to be removed and subgrade regulated with approved structural material.
- Pavement sub-base and bedding to kerb and channel is to extend 150mm behind the back of kerb as per IDM SD 145.
- Vehicle crossings are to be constructed in accordance with City of Greater Geelong Design Note No. 4 and detail sheet 4. All concrete is to be 32MPa.
- Paths are to be constructed in accordance with IDM SD 205 using 32MPa concrete.
- Refer to the City of Greater Geelong Design Note No. 12 with additional details on the quality and finish of concrete infrastructure.

### DRAINAGE NOTES

- All stormwater pipes are to be Class 2 with rubber ringed joints unless noted otherwise.
- Stormwater pipes under road pavements, driveways, footpaths, parking bays and behind kerb and channel to be backfilled with 20mm Class 3 fine crushed rock (wetmix) compacted to 98% modified in maximum 150mm layers.
- Stormwater pipes under roads are to have 2% stabilised sand embedment to springline.
- House drains are to be offset 6.0m from the low side boundary (or driveway side for lots narrower than 12.0m) unless noted otherwise. They are to be constructed at a minimum depth of 600mm below the lowest corner level. The house drain location to be inscribed with a 50mm high "H" on the back of kerb.
- Property inlets are to be offset 1.0m from low side boundary unless noted otherwise. They are to be constructed at a minimum depth of 600mm below finished surface level.
- Subsoil drains shall be installed behind all kerb and channel in accordance with IDM SD 145.
- A CCTV report must be provided on all drainage pipelines prior to practical completion of works.
- No stormwater drainage pipes shall be subjected to construction traffic loading during construction unless the pipe strength characteristics have been computed and approved by the contractors engineer. Computations are to accord with AS3725-1989 Loads on Buried Pipes.
- Concrete pipes damaged due to construction loads shall be repaired at the contractors cost.

### SERVICES NOTES

- The contractor shall co-operate with all service authorities and shall ensure that all services are installed prior to the final pavement course.
- All service trenches under road pavements, vehicle crossings and footpaths to be backfilled with crushed rock in accordance with Council's specification.
- The contractor shall check with the superintendent the exact location of all services prior to the installation of conduits.
- Conduit locations are subject to amendment and conduits shall not be laid until written approval is given by the superintendent.
- Gas and water conduits are to be 50mm PVC with separate conduits for DW and NDW property connections. They are to be laid at a minimum depth of 600mm below road finished surface levels to the satisfaction of the superintendent.
- Gas mains, fittings and marker tape are to be supplied by the gas authority. Excavation, supply and placement of required backfill to be by others.
- Two weeks notification of commencement of excavation works shall be given to the gas authority.
- Electrical distribution pits must have a minimum clearance of 300mm from edge of path.
- Communications conduits and pits are to be provided in accordance with the approved NBN plans.
- Both kerbs are to be marked with the letters G, W, E and T above the conduit locations.

### SIGNS AND PAVEMENT MARKINGS

- All pavement markings, signing & traffic control devices for this project to be in accordance with Australian Standard AS1742.
- All line marking to be long life road marking, with longitudinal lines in thermoplastic and transverse markings in cold applied.

DRAWING INDEX		DRAWING No.
REFERENCE		
Locality Plan, Drawing Index & General Notes		0352-07-R01
Layout Plans		0352-07-R02 to R03
Allotment Benching Plan		0352-07-R04
Pavement Compositions & Details		0352-07-R05
Typical Sections		0352-07-R06
Road Longitudinal Sections	Amphitrite Way	0352-07-R07
	Whitewing Street	0352-07-R07
Cross Sections	Amphitrite Way	0352-07-R08
	Whitewing Street	0352-07-R09 to R10
Intersection Details		0352-07-R11
Signage & Linemarking Plan		0352-07-R12
Drainage Longitudinal Sections		0352-07-R13 to R15
Pit Schedule		0352-07-R16

Rev	Amendment	Des/Dt	App'd	Date
A	Initial Issue	GP/DP	MG	19/08/22
1	Approved for construction	GP/DP	MG	28/10/22

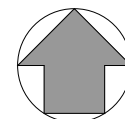

Principal  
  
**HARRIOTT**  
 AT ARMSTRONG CREEK  
 Jinding Australia  
 Level 53, 525 Collins Street  
 Melbourne Vic 3000

**GPR Consulting**  
  
 GPR Consulting Pty Ltd  
 ABN 98 140 136 205  
 Suite 217, 202 Jells Road  
 Wheelers Hill Vic 3150  
 Telephone 0456 634 727  
 © GPR Consulting Pty Ltd

Council City of Greater Geelong  
 Project **Harriott at Armstrong Creek Stage 7**  
 Title Locality Plan, Drawing Index & General Notes  
 Designed: G.Pratt  
 Drafted: D.Pratt  
 Authorised: M.Graham  
 Date: August 2022

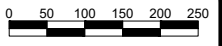
Scale @ A1: 1:5000  
  
 Drawing No. **0352-07-R01**  
 Sheet 01 of 16  
 Rev **1**

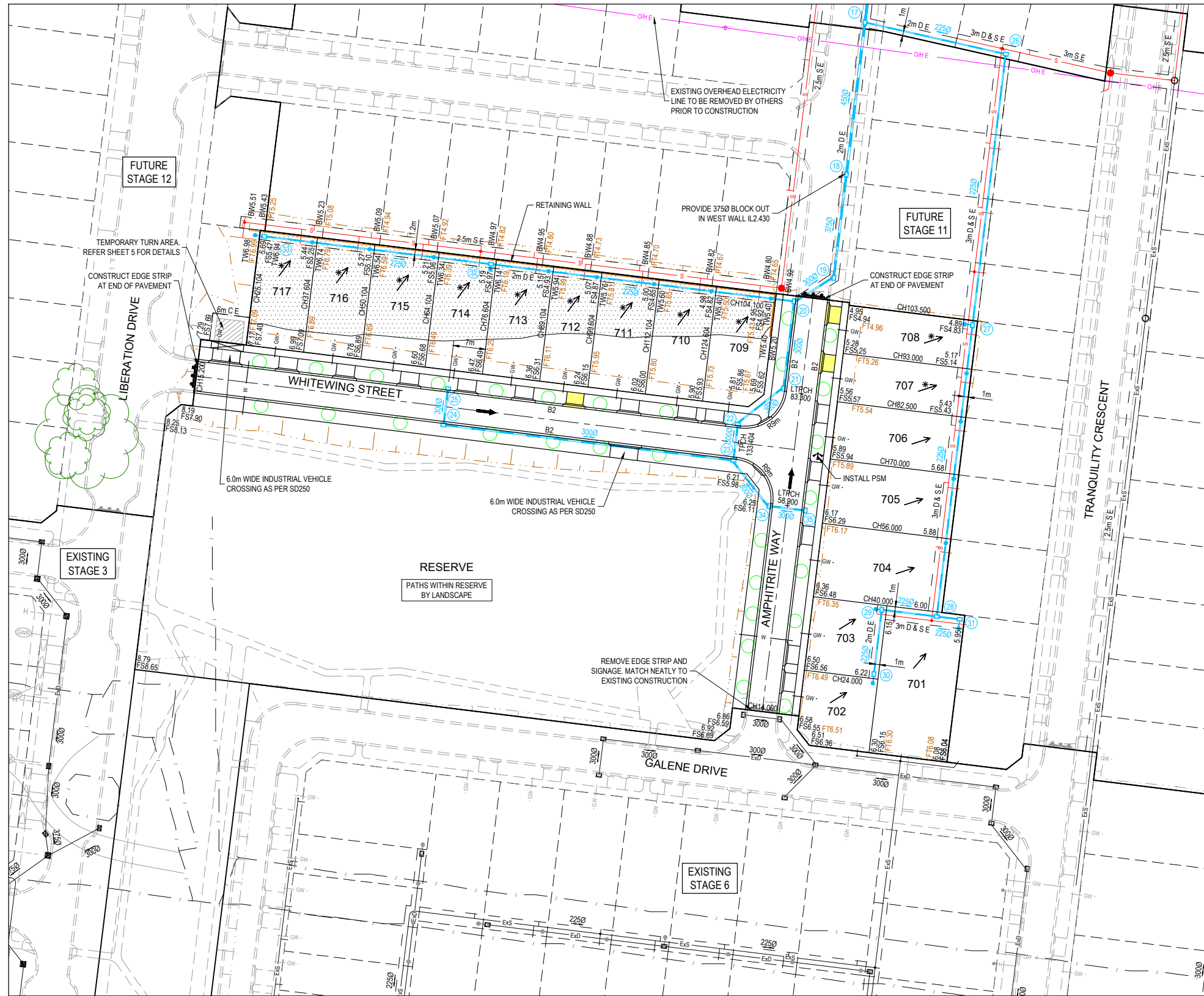

VEHICLE CROSSINGS		
STANDARD VEHICLE CROSSINGS ARE TO BE 4.0m WIDE OFFSET 1.0m FROM THE SIDE BOUNDARY		
NON STANDARD VEHICLE CROSSINGS ARE TO BE LOCATED AS PER BELOW		
LOT	WIDTH (m)	OFFSET (m)
707	3.7	0.6
708	3.7	0.6
712	3.7	0.6

**NOTE: STREET TREES**  
INDICATIVE STREET TREE LOCATION. ULTIMATE LOCATION TO BE PROVIDED BY THE LANDSCAPE ARCHITECTS.

**WARNING**  
**BEWARE OF UNDERGROUND SERVICES**  
The locations of underground services are approximate only and their exact position should be proven on site. No guarantee is given that all existing services are shown. Locate all underground services before commencement of works.  
**DIAL 1100 BEFORE YOU DIG**  
www.1100.com.au

SERVICES OFFSET SCHEDULE									
STREET NAME	ROAD RESERVE	BACK OF KERB	SEWER	GAS	NON DRINKING WATER	DRINKING WATER	COMMUNICATIONS	ELECTRICITY	LIGHT POLES
AMPHITRITE WAY (LOT 702 TO 705)	14.50	2.85 W / 4.35 E	-	2.10 E	2.60 E	3.10 E	0.55 W	1.30 W	1.95 W
AMPHITRITE WAY (LOT 706 TO 708)	16.00	4.35	-	2.10 E	2.60 E	3.10 E	1.85 S	2.60 W	3.45 W
WHITEWING STREET	14.50	2.85 S / 4.35 N	-	2.10 N	2.60 N	3.10 N	0.55 S	1.30 S	1.95 S

Rev	Amendment	Des/Dft	App'd	Date	Legend	
A	Initial Issue	GP/DP	MG	19/08/22	Existing Drainage — H — Ex D —	Drainage — H —
B	PSM relocated	GP/DP	MG	11/10/22	Existing Sewer — Ex S —	Finished Surface Level at Title FS135.12
1	Approved for construction	GP/DP	MG	28/10/22	Existing Gas — Ex G —	Level at Top/Toe of Batter/Ridge FT135.12
					Existing Electricity UG — Ex E —	Centreline Chaining CH50.370
					Existing Electricity OH — Ex E —	Gas & Water Conduits — GW —
					Existing Communications — Ex T —	Direction of Lot Fall —
					Existing Drinking Water — Ex DW —	Direction of Overland Flow —
					Existing Non Drinking Water — Ex NDW —	Allotment to be Evenly Graded *
					Existing Swale Drain —	Structural Fill > 200mm
						Vehicle Crossings
						Concrete Infill

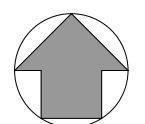

Principal  
**HARRIOTT**  
AT ARMSTRONG CREEK  
Jinding Australia  
Level 53, 525 Collins Street  
Melbourne Vic 3000

**GPR Consulting**  
GPR Consulting Pty Ltd  
ABN 98 140 136 205  
Suite 217, 202 Jells Road  
Wheeters Hill Vic 3150  
Telephone 0456 634 727  
© GPR Consulting Pty Ltd

Council	City of Greater Geelong	Scale @ A1:	1:500
Project	Harriott at Armstrong Creek Stage 7	0 5 10 15 20 25	
Title	Layout Plan Sheet 1 of 2	Drawing No.	0352-07-R02
Designed:	G.Pratt	Authorised:	M.Graham
Drafted:	D.Pratt	Date:	August 2022
Sheet	02 of 16	Rev	1

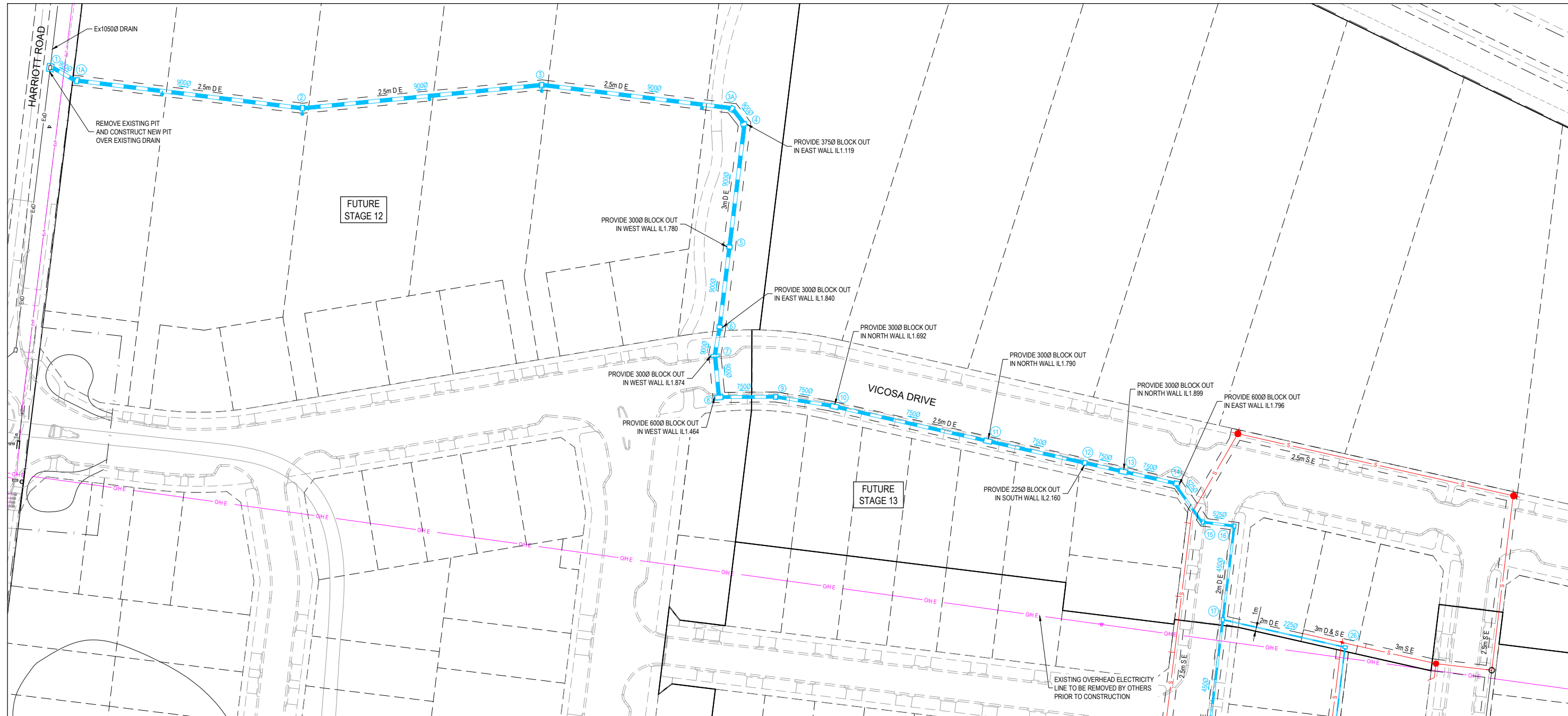

FOR CONTINUATION REFER 0352-07-R02

VEHICLE CROSSINGS		
STANDARD VEHICLE CROSSINGS ARE TO BE 4.0m WIDE OFFSET 1.0m FROM THE SIDE BOUNDARY		
NON STANDARD VEHICLE CROSSINGS ARE TO BE LOCATED AS PER BELOW		
LOT	WIDTH (m)	OFFSET (m)
707	3.7	0.6
708	3.7	0.6
712	3.7	0.6

**NOTE: STREET TREES**  
INDICATIVE STREET TREE LOCATION. ULTIMATE LOCATION TO BE PROVIDED BY THE LANDSCAPE ARCHITECTS.

**WARNING**  
**BEWARE OF UNDERGROUND SERVICES**  
The locations of underground services are approximate only and their exact position should be proven on site. No guarantee is given that all existing services are shown. Locate all underground services before commencement of works.  
**DIAL 1100 BEFORE YOU DIG**  
www.1100.com.au

Rev	Amendment	Des/Dt	App'd	Date
A	Initial Issue	GP/DP	MG	19/08/22
B	Drain 1 to 4 amended	GP/DP	MG	11/10/22
1	Approved for construction	GP/DP	MG	28/10/22

Legend	
Existing Drainage — H — Ex D —	Drainage — H —
Existing Sewer — Ex S —	Main Drainage — H —
Existing Gas — Ex G —	Sewer — S —
Existing Electricity UG — Ex E —	Swale Drain —
Existing Electricity OH — Ex E —	Gas & Water Conduits — GW —
Existing Communications — Ex T —	Direction of Lot Fall —
Existing Drinking Water — Ex DW —	Direction of Overland Flow —
Existing Non Drinking Water — Ex NDW —	Allotment to be Evenly Graded —
Existing Swale Drain —	Vehicle Crossings —
Existing Surface Level at Title 135.12	Finished Surface at Title FS135.12
Level at Top/Toe of Batter/Ridge FT135.12	Centreline Chaining CH50.370
Sleeper Retaining Wall	Rock Retaining Wall
PSM / TBM	Structural Fill > 200mm
Concrete Infill	

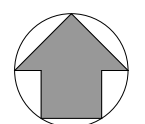

Principal  
  
 Jinding Australia  
 Level 53, 525 Collins Street  
 Melbourne Vic 3000

**GPR Consulting**  
 GPR Consulting Pty Ltd  
 ABN 98 140 136 205  
 Suite 217, 202 Jellis Road  
 Wheelers Hill Vic 3150  
 Telephone 0456 634 727  
 © GPR Consulting Pty Ltd

Council City of Greater Geelong  
 Project **Harriott at Armstrong Creek Stage 7**  
 Title **Layout Plan Sheet 2 of 2**  
 Designed: G.Pratt  
 Drafted: D.Pratt  
 Authorised: M.Graham  
 Date: August 2022

Scale @ A1: 1:500  
  
 Drawing No. **0352-07-R03**  
 Sheet 03 of 16  
 Rev **1**

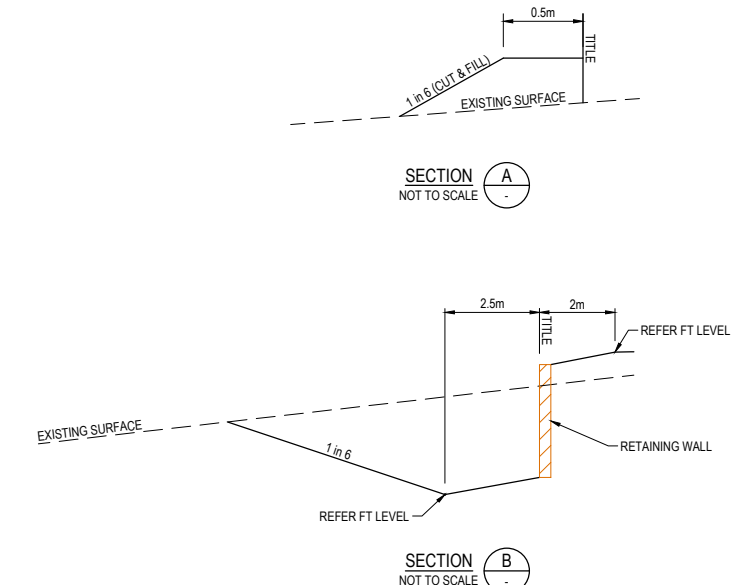
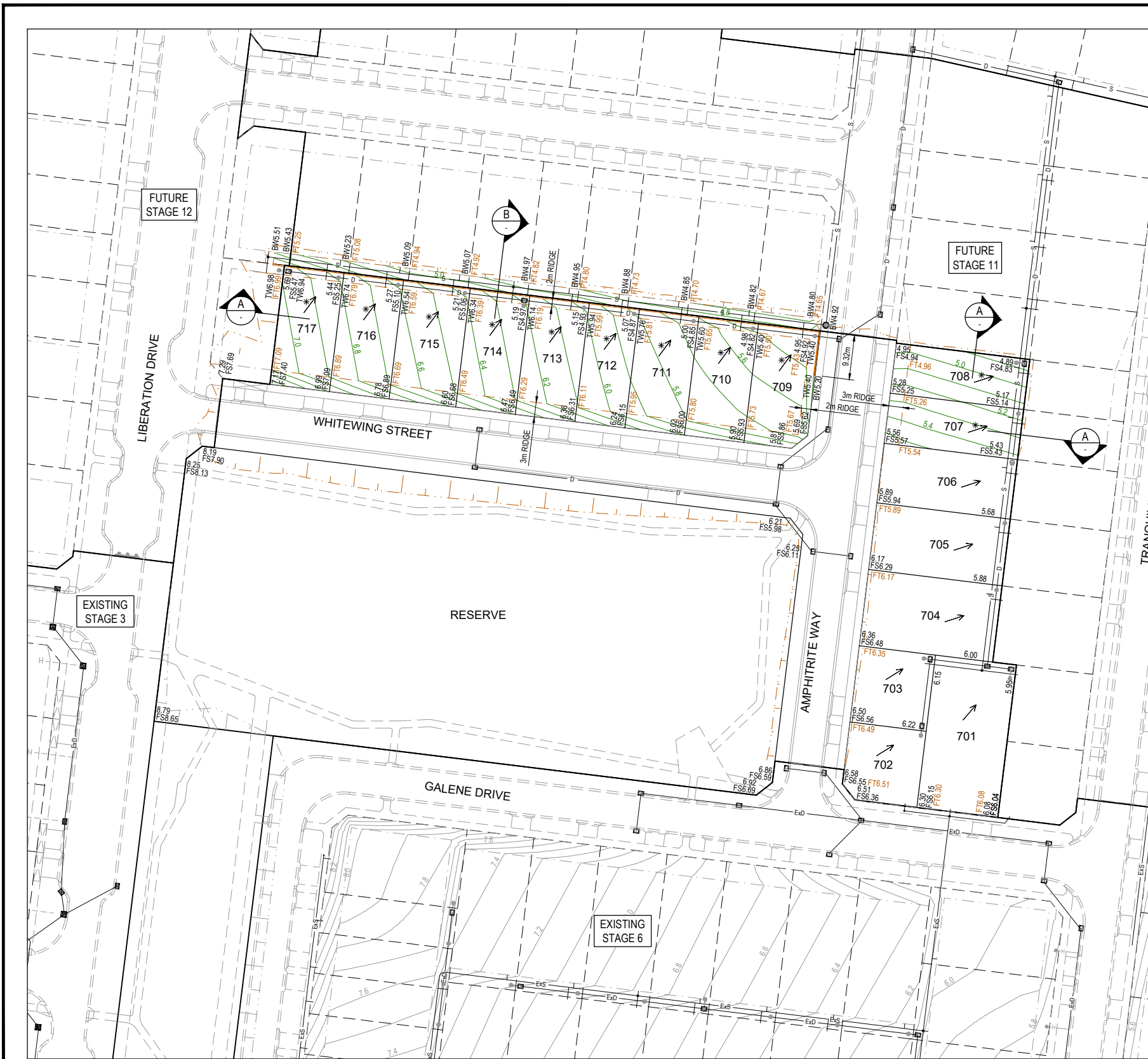

**NOTES: WALL SUBSOIL DRAIN**

- NO SUBSOIL DRAINS ARE TO CROSS A TITLE BOUNDARY.
- HIGH SIDE LOTS ARE TO CONNECT TO THE PROPERTY INLET IN THE LOW CORNER.
- LOW SIDE LOTS ARE TO CONNECT TO THE HOUSE DRAIN AT THE FRONT.

**NOTES: SEWERS**

- REFER TO STANDARD DRAWING MRWA-S-209 FOR REQUIREMENTS OF SEWERS IN THE VICINITY OF RETAINING WALLS.
- PIERS ARE TO BE LOCATED SO THE SEWER CROSSING OF THE WALL IS CENTRALLY BETWEEN PIERS WITH A MINIMUM 0.4m CLEARANCE.

**NOTES: RETAINING WALL**

- REFER TO STRUCTURAL PLANS FOR DETAILS OF THE RETAINING WALL.
- A BUILDING PERMIT IS TO BE PROVIDED TO THE SUPERINTENDENT PRIOR TO CONSTRUCTION.
- CERTIFICATION FROM A QUALIFIED STRUCTURAL ENGINEER IS REQUIRED POST CONSTRUCTION.
- PIERS TO ALIGN WITH TITLE BOUNDARIES ALONG HIGH SIDE OF WALL.

**WARNING**  
**BEWARE OF UNDERGROUND SERVICES**  
 The locations of underground services are approximate only and their exact position should be proven on site. No guarantee is given that all existing services are shown. Locate all underground services before commencement of works.  
**DIAL 1100 BEFORE YOU DIG**  
 www.1100.com.au

Rev	Amendment	Des/DR	App'd	Date
A	Initial Issue	GP/DP	MG	19/08/22
1	Approved for construction	GP/DP	MG	28/10/22

Legend	
	Drain & Property Inlet
	House Drain
	Sewer
	Swale Drain
	Existing Drain
	Existing House Drain
	Existing Sewer
	Existing Swale Drain
	Vehicle Crossings
	Existing Surface Level at Title
	Finished Surface at Title
	Level at Top/Toe of Batter/Ridge
	Top of Wall Level
	Bottom of Wall Level
	Design Contours
	Existing Contours
	Batter
	Ridge
	Steeper Retaining Wall
	Rock Retaining Wall
	Direction of Lot Fall
	Allotment to be Evenly Graded

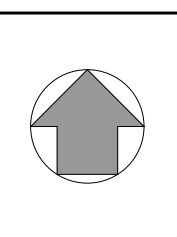

Principal  
  
 Jinding Australia  
 Level 53, 525 Collins Street  
 Melbourne Vic 3000

**GPR Consulting**  
 GPR Consulting Pty Ltd  
 ABN 98 140 136 205  
 Suite 217, 202 Jells Road  
 Wheelers Hill Vic 3150  
 Telephone 0456 634 727  
 © GPR Consulting Pty Ltd

Council	City of Greater Geelong	Scale @ A1:	1:500
Project	Harriott at Armstrong Creek Stage 7		
Title	Allotment Benching Plan	Drawing No.	0352-07-R04
Designed:	G.Pratt	Authorised:	M.Graham
Drafted:	D.Pratt	Date:	August 2022
Sheet	04 of 16	Rev	1

# PAVEMENT COMPOSITIONS

## AMPHITRITE WAY & WHITEWING STREET

PAVEMENT LAYER	LAYER THICKNESS (mm)	MATERIAL
WEARING COURSE ASPHALT	30	SIZE 10 TYPE N ASPHALT (CLASS 170 BINDER)
		PRIME COAT
BASE	160	SIZE 20 CLASS 2 FINE CRUSHED ROCK (COMPACTED TO 99% MODIFIED)
SUBBASE	110	SIZE 20 CLASS 3 FINE CRUSHED ROCK (COMPACTED TO 98% MODIFIED)
CAPPING LAYER	150	TYPE A CAPPING MATERIAL OR APPROVED EQUIVALENT (REFER NOTES)
TOTAL DEPTH	450	SUBGRADE IMPROVEMENT AS DIRECTED BY THE SUPERINTENDENT (CBR <sub>2</sub> ≥2%)

- NOTES:
- REFER TO DOUGLAS PARTNERS GEOTECHNICAL REPORT (REFERENCE 87044.02 R.001 AND R.002)
  - CAPPING LAYER MATERIAL TO COMPLY WITH THE FOLLOWING:
    - CBR ≥ 8%
    - SWELL ≤ 1.0
    - PERMEABILITY  $K \leq 5 \times 10^{-9}$  m/s
    - COMPACTED TO A MINIMUM DENSITY RATIO OF 98% AS PER AS1289.

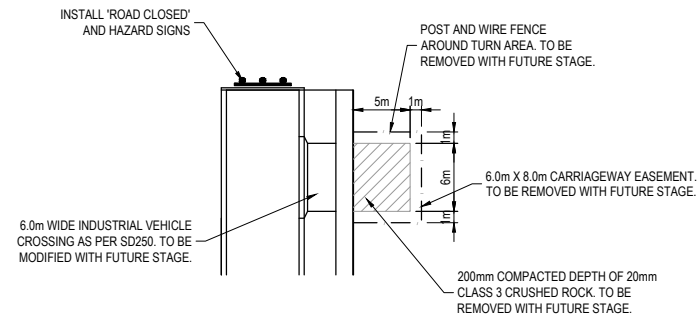

TEMPORARY TURN AROUND AREA DETAIL  
NOT TO SCALE

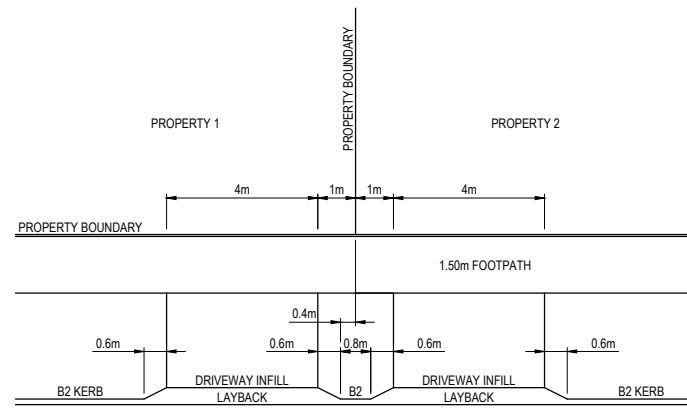

STANDARD VEHICLE CROSSING DETAIL  
NOT TO SCALE

- NOTE: VEHICLE CROSSINGS**
- STANDARD VEHICLE CROSSINGS ARE TO BE CONSTRUCTED AS PER THE ABOVE DETAIL.
  - NON STANDARD VEHICLE CROSSING WIDTH AND OFFSET ARE SHOWN ON THE LAYOUT PLAN.
  - COMPOSITION TO CONSIST OF 125mm DEPTH OF 32MPa CONCRETE WITH SL72 MESH CENTRALLY ON A 100mm DEPTH 20mm CLASS 3 FINE CRUSHED ROCK BASE (COMPACTED TO 97% MODIFIED).

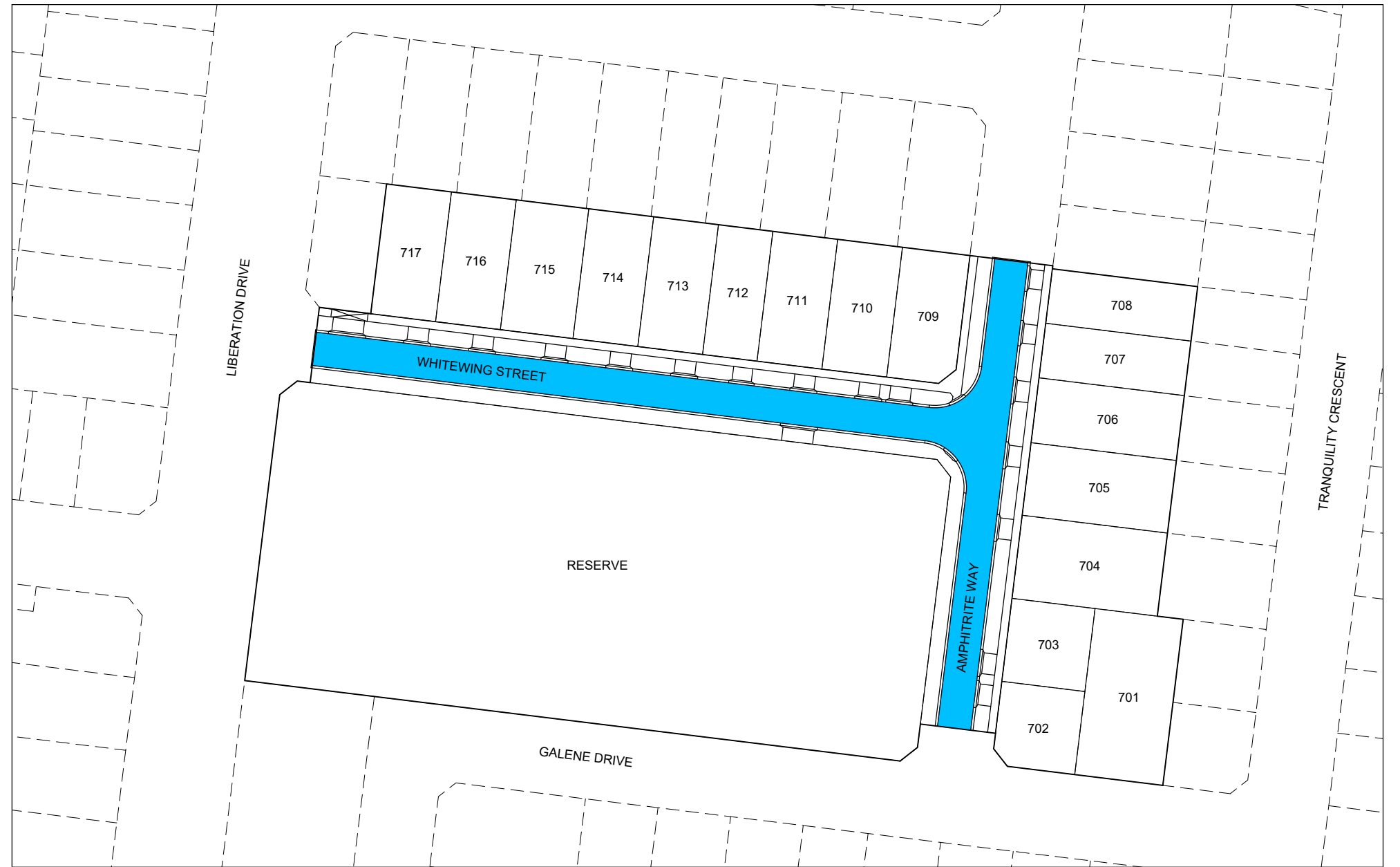

Rev	Amendment	Des/Dt	App'd	Date
A	Initial Issue	GP/DP	MG	19/08/22
1	Approved for construction	GP/DP	MG	28/10/22

Principal

**HARRIOTT**  
AT ARMSTRONG CREEK

Jinding Australia  
Level 53, 525 Collins Street  
Melbourne Vic 3000

**GPR Consulting**

GPR Consulting Pty Ltd  
ABN 98 140 136 205  
Suite 217, 202 Jellis Road  
Wheeters Hill Vic 3150  
Telephone 0456 634 727  
© GPR Consulting Pty Ltd

Council	City of Greater Geelong
Project	<b>Harriott at Armstrong Creek Stage 7</b>
Title	Pavement Compositions & Details
Designed:	G.Pratt
Authorised:	M.Graham
Drafted:	D.Pratt
Date:	August 2022

Scale @ A1:	1:500
Drawing No.	<b>0352-07-R05</b>
Sheet	05 of 16
Rev	<b>1</b>

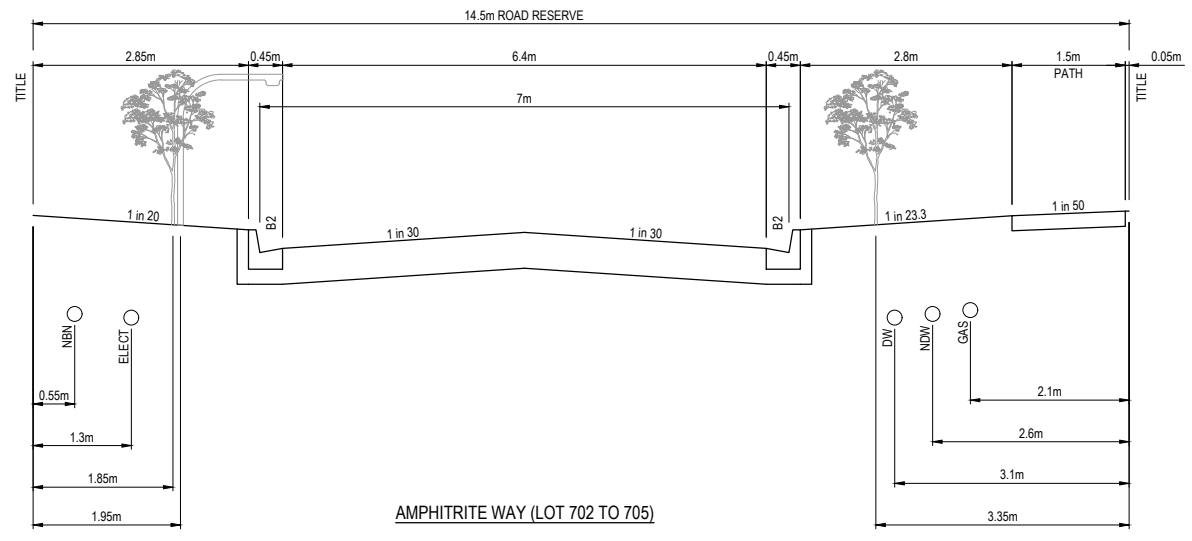

AMPHITRITE WAY (LOT 702 TO 705)

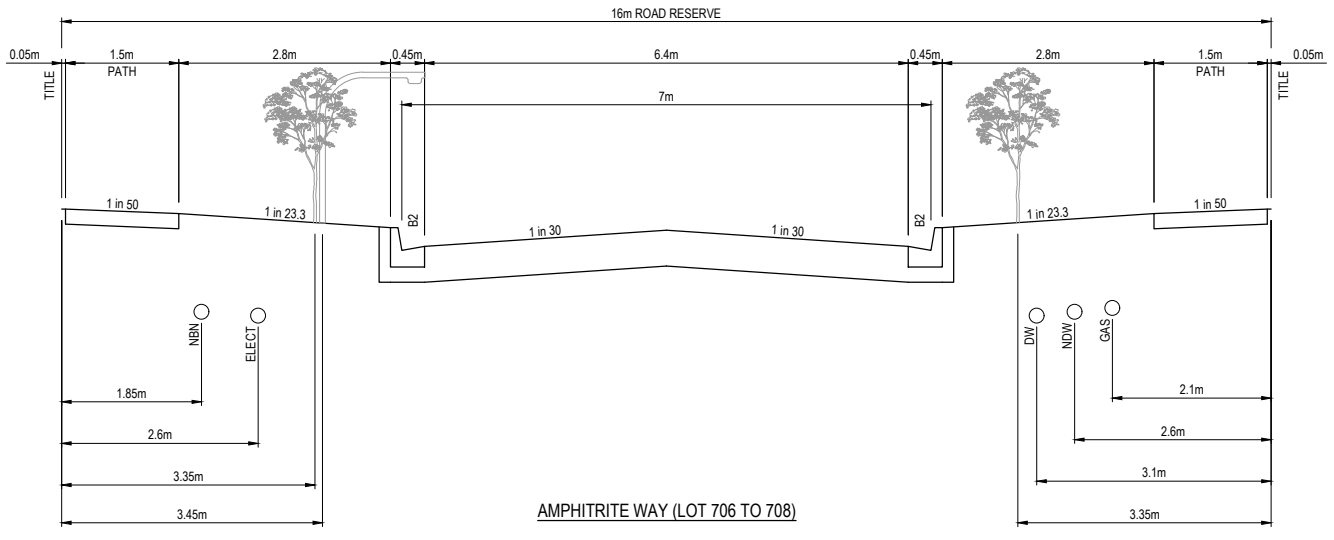

AMPHITRITE WAY (LOT 706 TO 708)

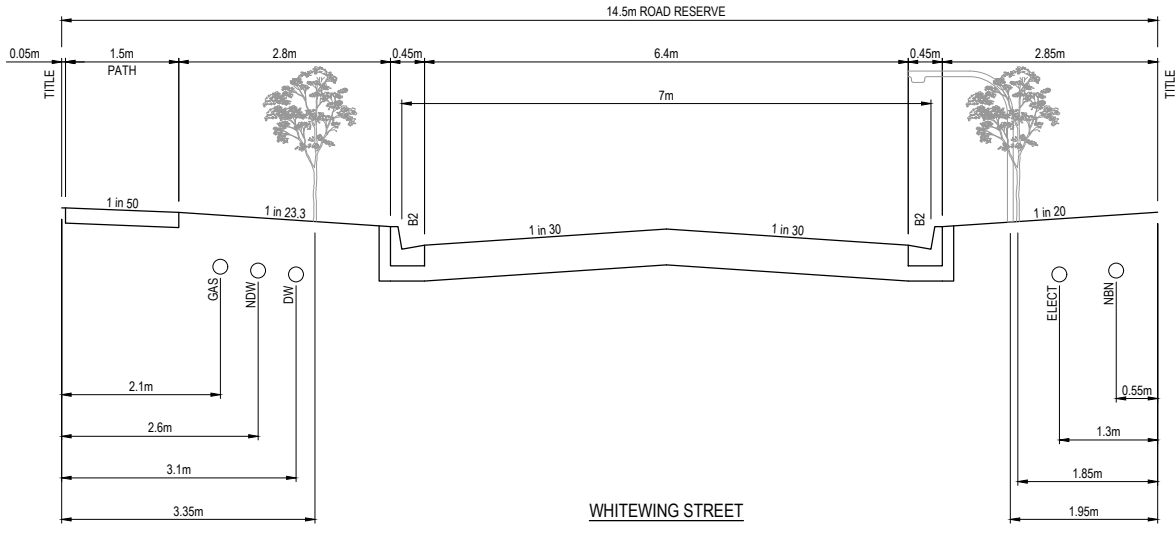

WHITEWING STREET

Rev	Amendment	Des/DR	App'd	Date
A	Initial Issue	GP/DP	MG	19/08/22
1	Approved for construction	GP/DP	MG	28/10/22

Principal

HARRIOTT  
AT ARMSTRONG CREEK

Jinding Australia  
Level 53, 525 Collins Street  
Melbourne Vic 3000

**GPR Consulting**

GPR Consulting Pty Ltd  
ABN 98 140 136 205  
Suite 217, 202 Jells Road  
Wheeters Hill Vic 3150  
Telephone 0456 634 727  
© GPR Consulting Pty Ltd

Council	City of Greater Geelong	Scale @ A1:	H1:50 V1:25
Project	Harriott at Armstrong Creek Stage 7		
Title	Typical Sections	Drawing No.	0352-07-R06
Designed:	G.Pratt	Authorised:	M.Graham
Drafted:	D.Pratt	Date:	August 2022
Sheet	06 of 16	Rev	1

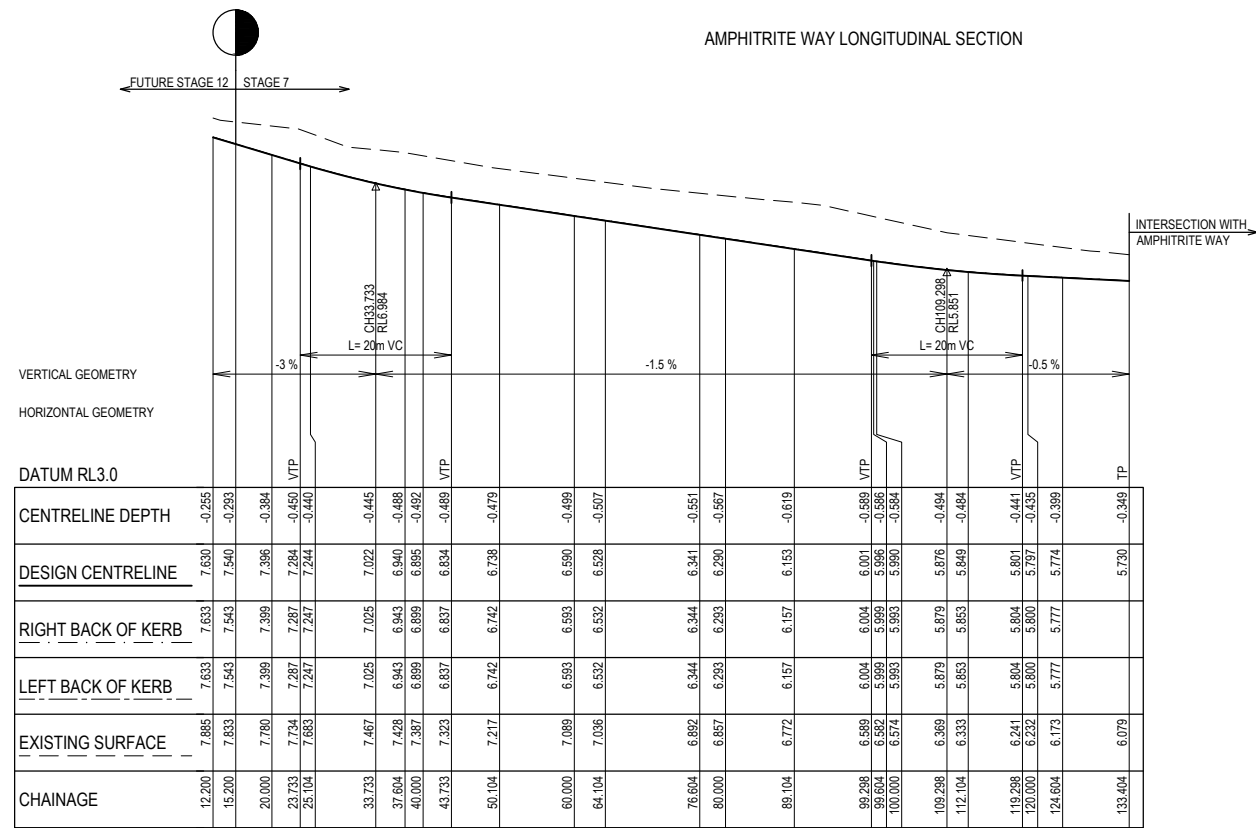
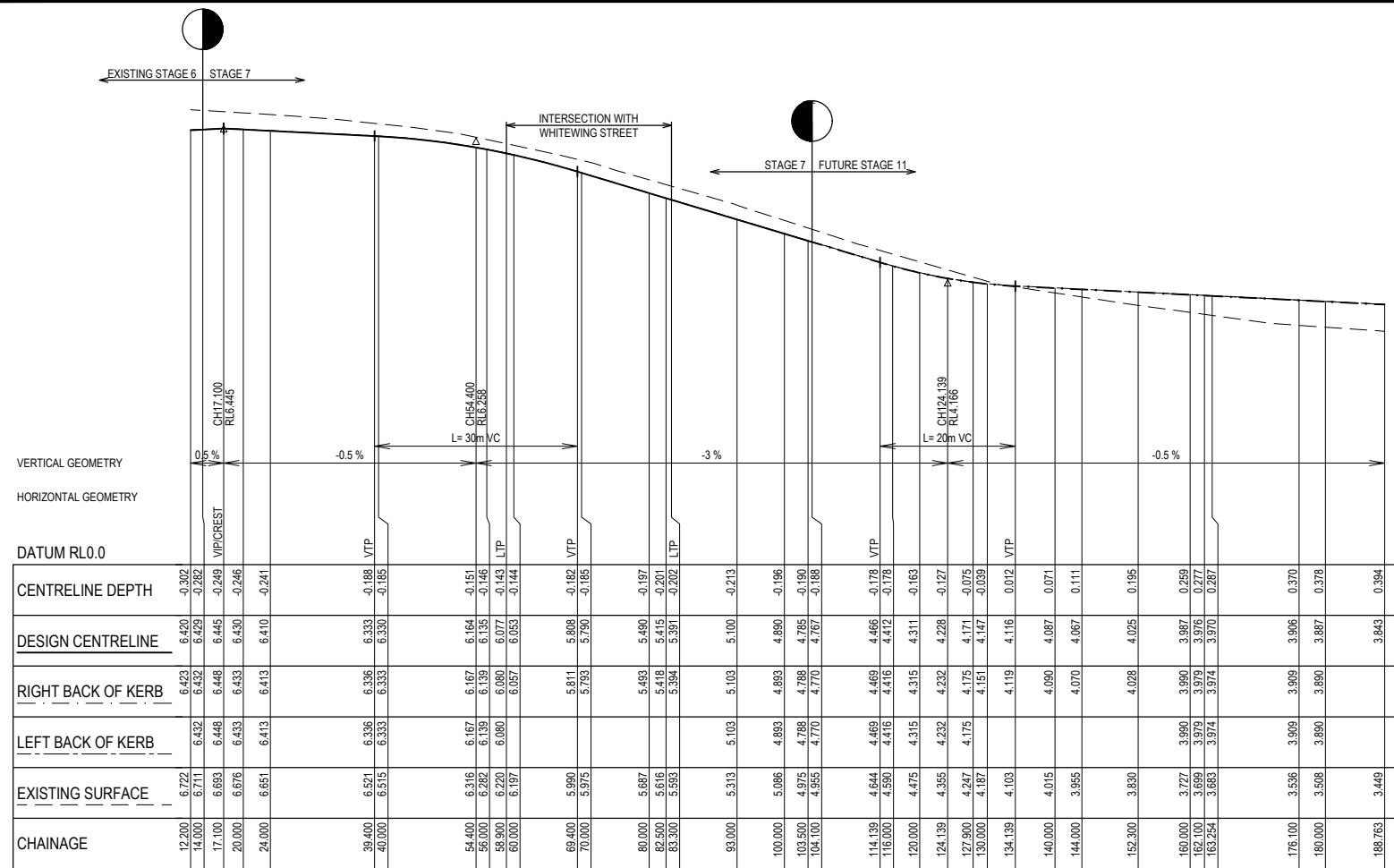

WHITEWING STREET LONGITUDINAL SECTION

Rev	Amendment	Des/Dt	App'd	Date	Legend
A	Initial Issue	GP/DP	MG	19/08/22	Existing Surface — — — —
1	Approved for construction	GP/DP	MG	28/10/22	Design Line — — — —
					Existing Design Line — — — —
					Future Design Line — — — —
					Left Back of Kerb — — — —
					Right Back of Kerb — — — —

Principal

Jinding Australia  
Level 53, 525 Collins Street  
Melbourne Vic 3000

GPR Consulting Pty Ltd  
ABN 98 140 136 205  
Suite 217, 202 Jells Road  
Wheeters Hill Vic 3150  
Telephone 0456 634 727  
© GPR Consulting Pty Ltd

Council	City of Greater Geelong	Scale @ A1:	H1:500 V1:50
Project	Harriott at Armstrong Creek Stage 7		
Title	Longitudinal Sections	Drawing No.	0352-07-R07
Designed:	G.Pratt	Authorised:	M.Graham
Drafted:	D.Pratt	Date:	August 2022
Sheet	07 of 16	Rev	1

**NOTE:**  
 1. WHERE ROAD PAVEMENTS ARE ABOVE THE STRIPPED SURFACE IT IS TO BE FILLED WITH SELECT MATERIAL EXTENDING 0.2m BELOW NATURAL SURFACE. SELECT FILL TO MEET CITY OF GREATER GEELONG REQUIREMENTS.  
 2. WHERE PATHS ARE ABOVE STRIPPED SURFACE IT IS TO BE FILLED WITH 20mm CLASS 3 CRUSHED ROCK EXTENDING 0.2m BELOW NATURAL SURFACE.

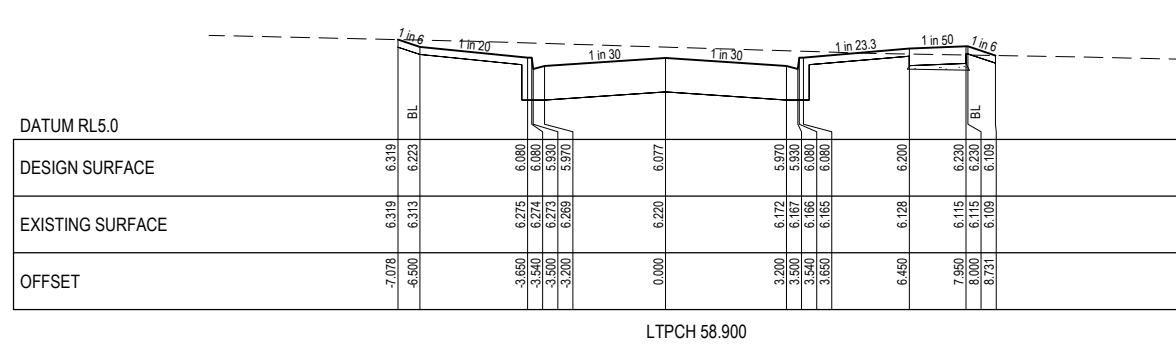
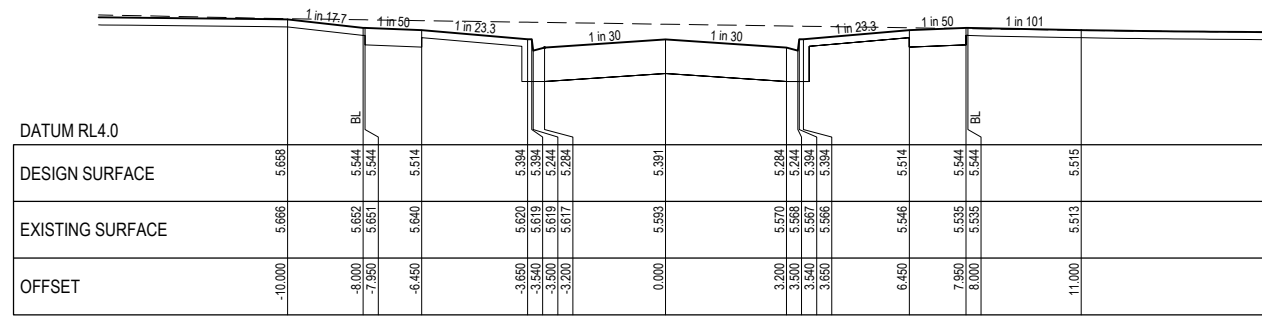
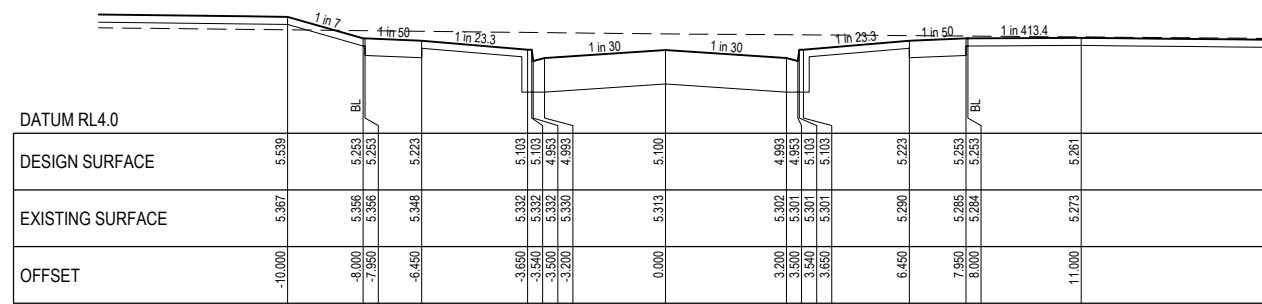
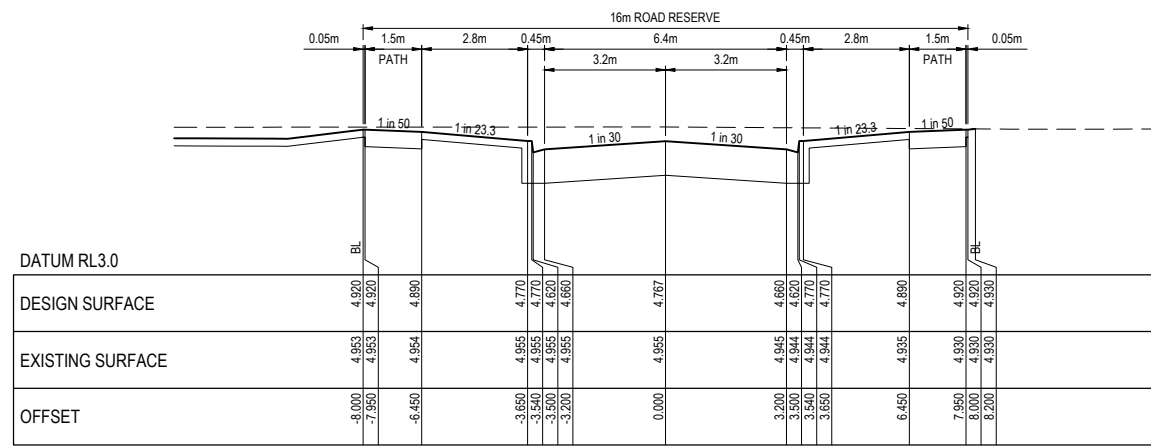
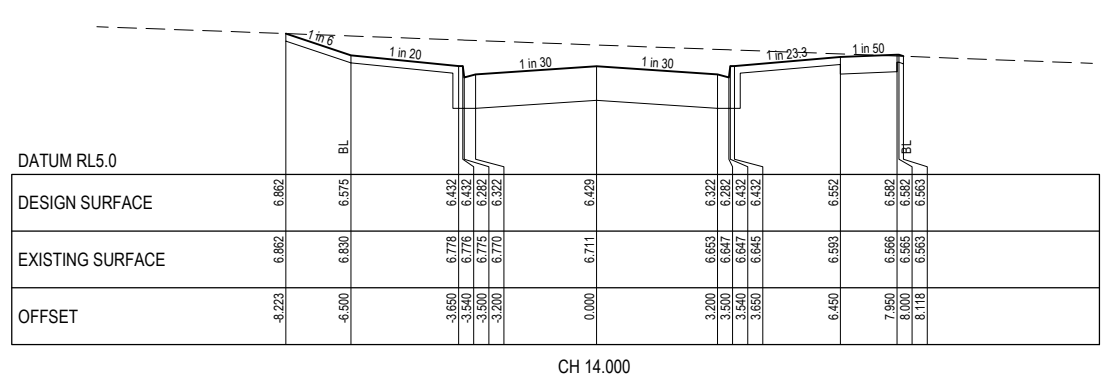
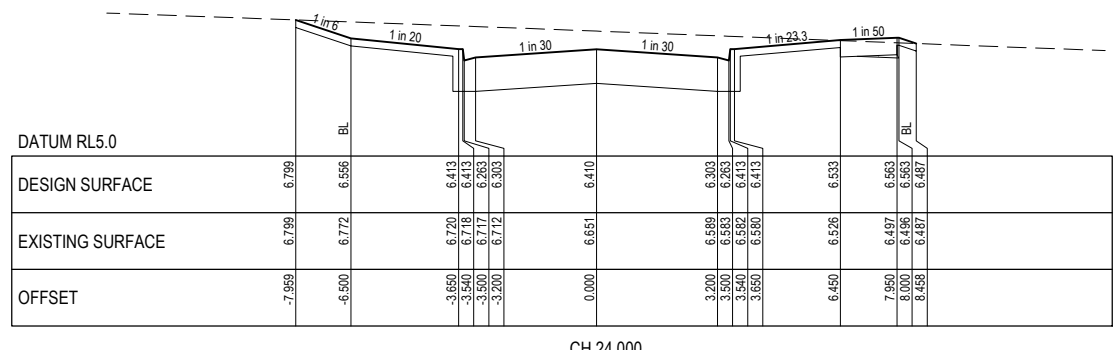
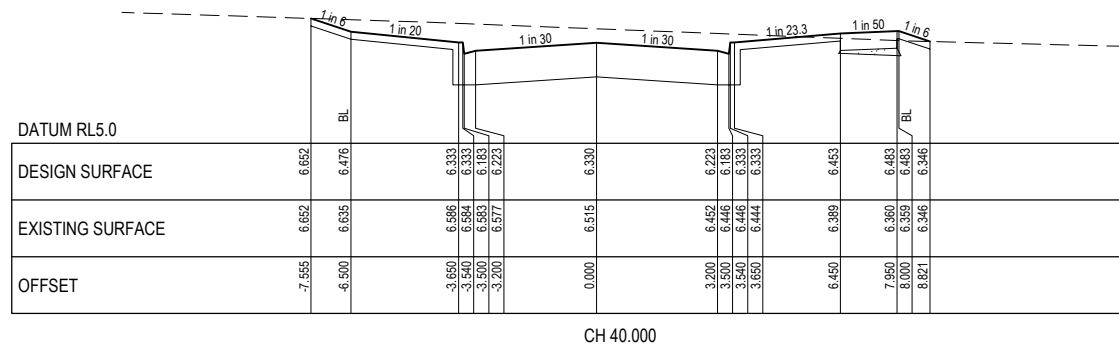
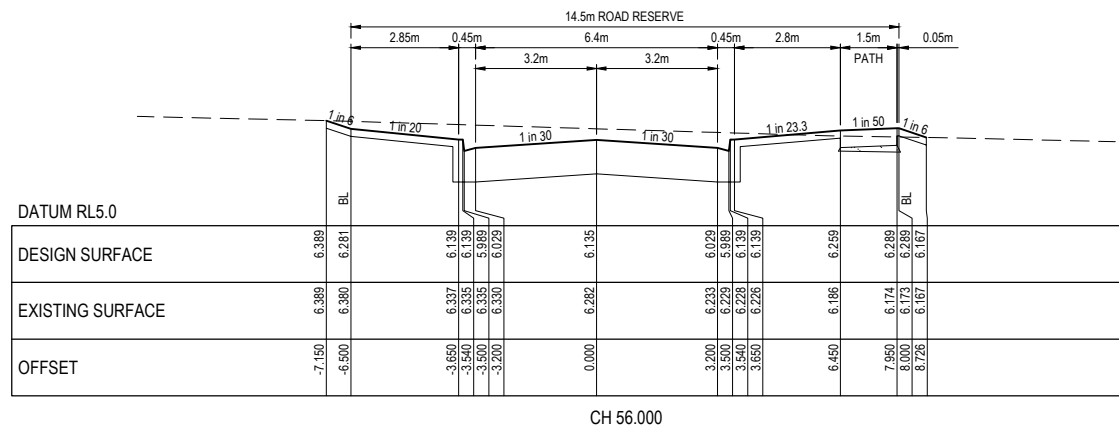

Rev	Amendment	Des/Dft	App'd	Date	Legend
A	Initial Issue	GP/DP	MG	19/08/22	Existing Surface
1	Approved for construction	GP/DP	MG	28/10/22	Design Line
					Future Surface
					Select Fill
					Crushed Rock

Principal
HARRIOTT AT ARMSTRONG CREEK

**GPR Consulting**

GPR Consulting Pty Ltd  
 ABN 98 140 136 205  
 Suite 217, 202 Jells Road  
 Wheelers Hill Vic 3150  
 Telephone 0456 634 727

Jinding Australia  
 Level 53, 525 Collins Street  
 Melbourne Vic 3000

**GPR Consulting**

GPR Consulting Pty Ltd  
 ABN 98 140 136 205  
 Suite 217, 202 Jells Road  
 Wheelers Hill Vic 3150  
 Telephone 0456 634 727

© GPR Consulting Pty Ltd

Council	City of Greater Geelong
Project	Harriott at Armstrong Creek Stage 7
Title	Cross Sections Amphitrite Way
Designed:	G.Pratt
Drafted:	D.Pratt
Authorised:	M.Graham
Date:	August 2022

Scale @ A1:	H1:100 V1:50
H0	1 2 3 4 5
V0	0.5 1 1.5 2 2.5
Drawing No.	0352-07-R08
Sheet	08 of 16
Rev	1



**NOTE:**  
 1. WHERE ROAD PAVEMENTS ARE ABOVE THE STRIPPED SURFACE IT IS TO BE FILLED WITH SELECT MATERIAL EXTENDING 0.2m BELOW NATURAL SURFACE. SELECT FILL TO MEET CITY OF GREATER GEELONG REQUIREMENTS.  
 2. WHERE PATHS ARE ABOVE STRIPPED SURFACE IT IS TO BE FILLED WITH 20mm CLASS 3 CRUSHED ROCK EXTENDING 0.2m BELOW NATURAL SURFACE.

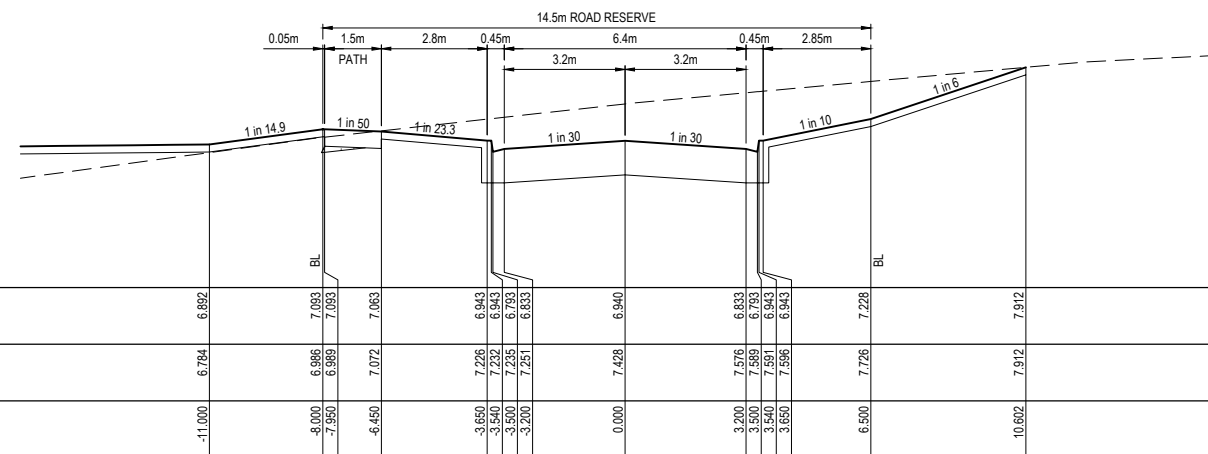

DATUM RL5.0	
DESIGN SURFACE	6.892
EXISTING SURFACE	6.784
OFFSET	-11.000

CH 37.604

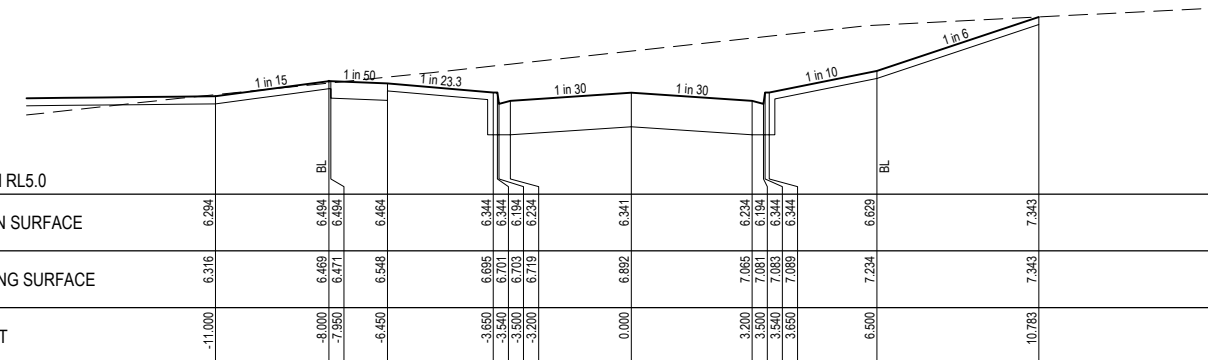

DATUM RL5.0	
DESIGN SURFACE	6.294
EXISTING SURFACE	6.316
OFFSET	-11.000

CH 76.604

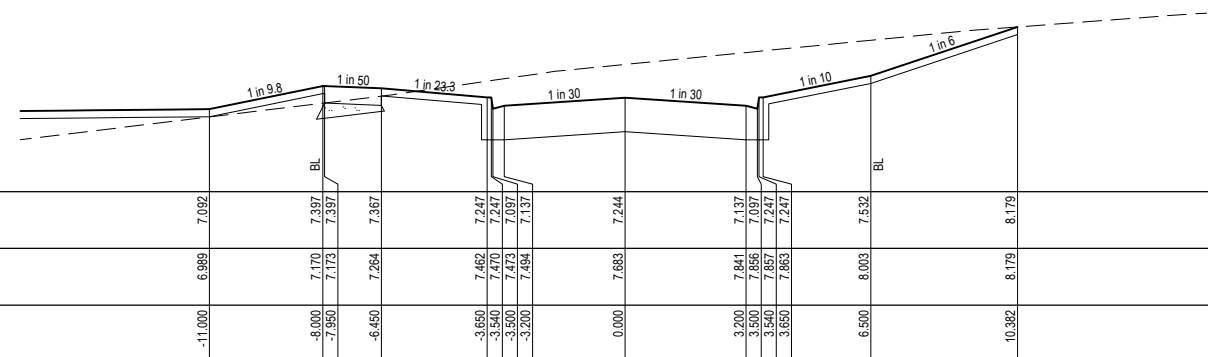

DATUM RL6.0	
DESIGN SURFACE	7.092
EXISTING SURFACE	6.989
OFFSET	-11.000

CH 25.104

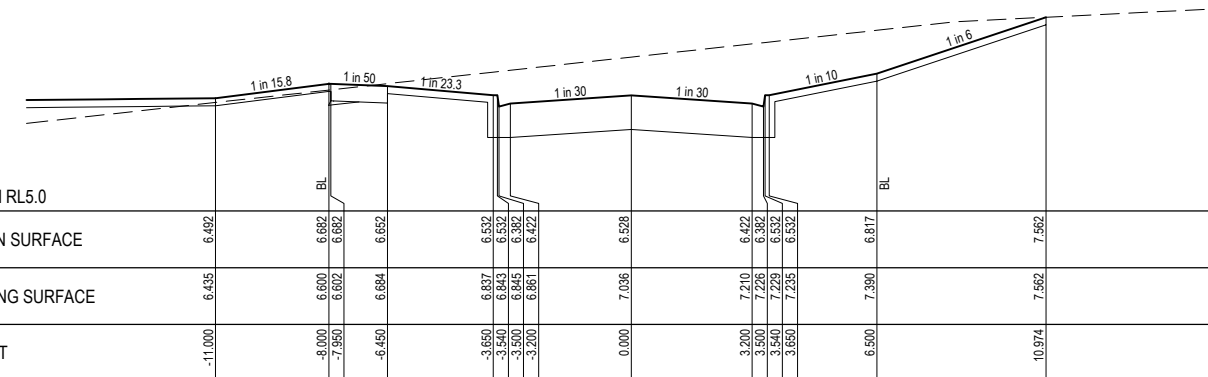

DATUM RL5.0	
DESIGN SURFACE	6.492
EXISTING SURFACE	6.435
OFFSET	-11.000

CH 64.104

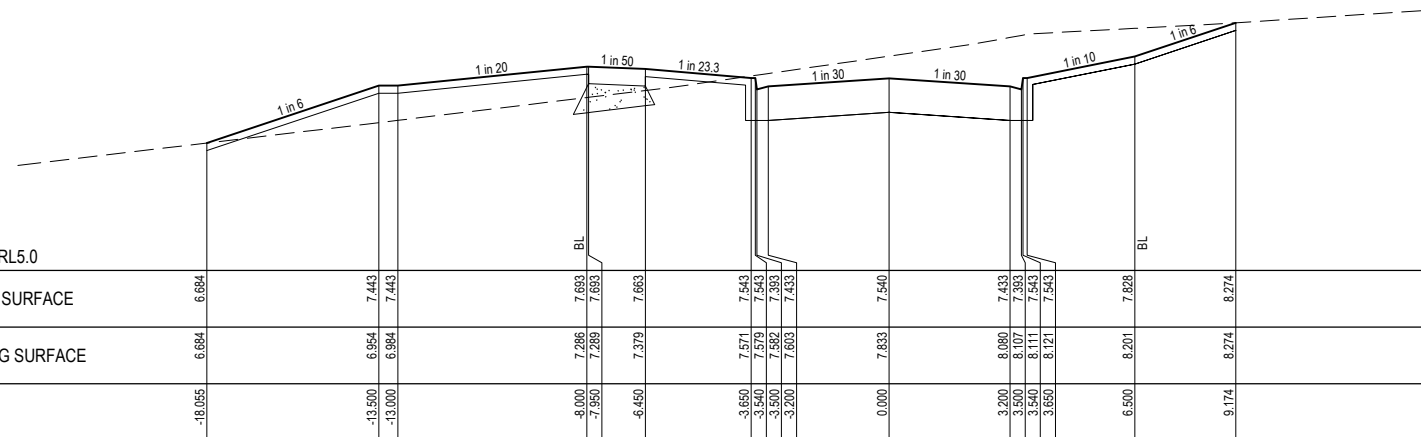

DATUM RL5.0	
DESIGN SURFACE	6.684
EXISTING SURFACE	6.684
OFFSET	-18.055

CH 15.200

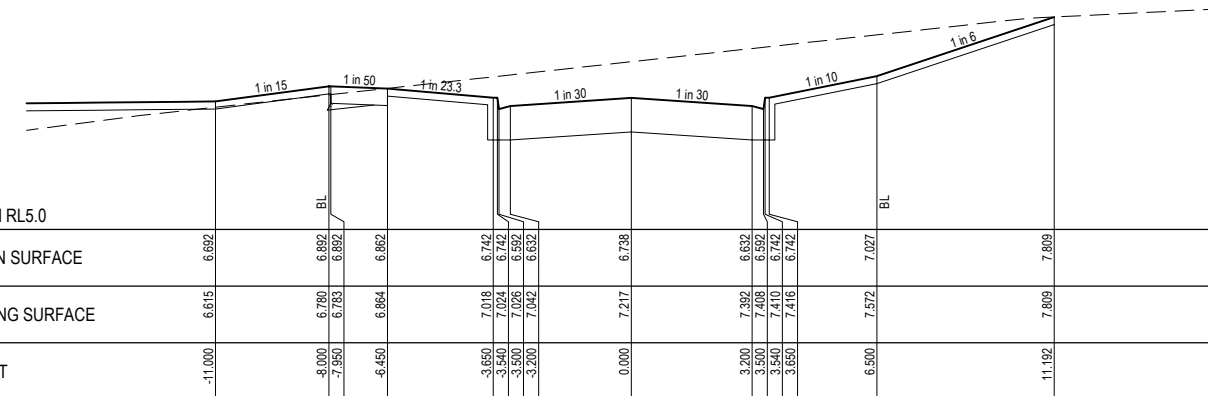

DATUM RL5.0	
DESIGN SURFACE	6.692
EXISTING SURFACE	6.615
OFFSET	-11.000

CH 50.104

Rev	Amendment	Des/Dt	App'd	Date	Legend
A	Initial Issue	GP/DP	MG	19/08/22	Existing Surface
1	Approved for construction	GP/DP	MG	28/10/22	Design Line
					Future Surface
					Select Fill
					Crushed Rock

Principal  
 HARRIOTT  
 AT ARMSTRONG CREEK  
 Jinding Australia  
 Level 53, 525 Collins Street  
 Melbourne Vic 3000

**GPR Consulting**  
 GPR Consulting Pty Ltd  
 ABN 98 140 136 205  
 Suite 217, 202, Jells Road  
 Wheelers Hill Vic 3150  
 Telephone 0456 634 727  
 © GPR Consulting Pty Ltd

Council City of Greater Geelong  
 Project Harriott at Armstrong Creek Stage 7  
 Title Cross Sections Whitewing Street - Sheet 1 of 2  
 Designed: G.Pratt  
 Drafted: D.Pratt  
 Authorised: M.Graham  
 Date: August 2022

Scale @ A1: H1:100 V1:50  
  
 Drawing No. 0352-07-R09  
 Sheet 09 of 16  
 Rev 1

**NOTE:**  
 1. WHERE ROAD PAVEMENTS ARE ABOVE THE STRIPPED SURFACE IT IS TO BE FILLED WITH SELECT MATERIAL EXTENDING 0.2m BELOW NATURAL SURFACE. SELECT FILL TO MEET CITY OF GREATER GEELONG REQUIREMENTS.  
 2. WHERE PATHS ARE ABOVE STRIPPED SURFACE IT IS TO BE FILLED WITH 20mm CLASS 3 CRUSHED ROCK EXTENDING 0.2m BELOW NATURAL SURFACE.

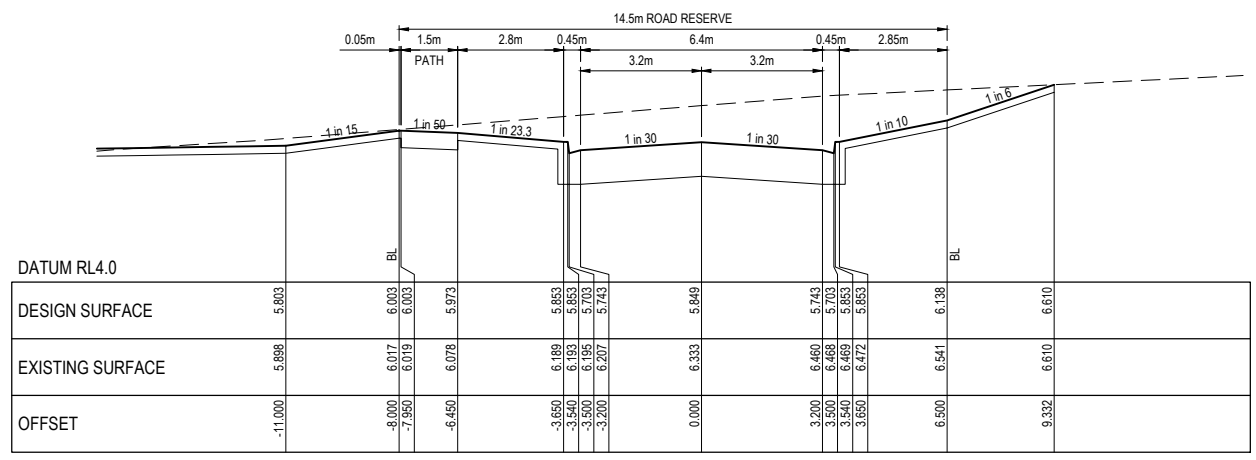

CH 112.104

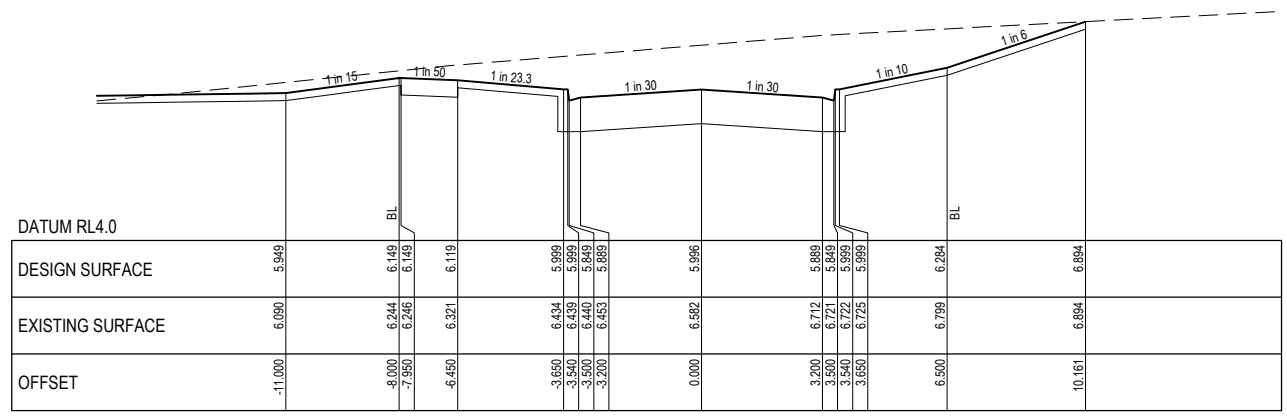

CH 99.604

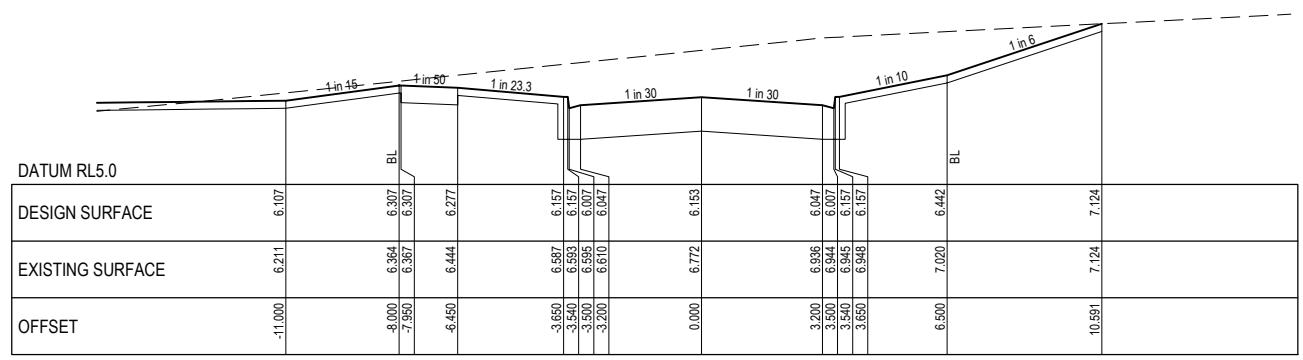

CH 89.104

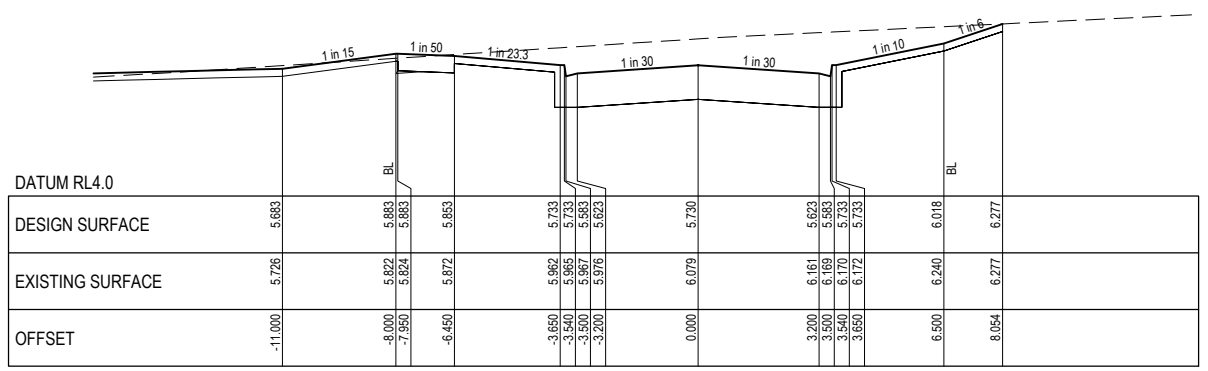

TPCH 133.404

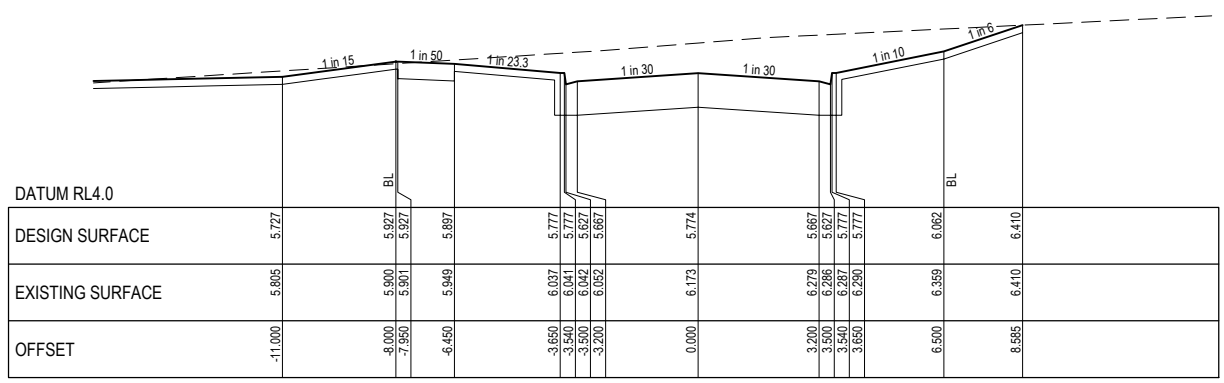

CH 124.604

Rev	Amendment	Des/Dft	App'd	Date	Legend
A	Initial Issue	GP/DP	MG	19/08/22	Existing Surface
1	Approved for construction	GP/DP	MG	28/10/22	Design Line
					Future Surface
					Select Fill
					Crushed Rock

Principal  
 HARRIOTT  
 AT ARMSTRONG CREEK

Principal  
 HARRIOTT  
 AT ARMSTRONG CREEK

**GPR Consulting**  
 GPR Consulting Pty Ltd  
 ABN 98 140 136 205  
 Suite 217, 202, Jells Road  
 Wheelers Hill Vic 3150  
 Telephone 0456 634 727  
 © GPR Consulting Pty Ltd

Council City of Greater Geelong  
 Project Harriott at Armstrong Creek Stage 7  
 Title Cross Sections Whitewing Street - Sheet 2 of 2  
 Designed: G.Pratt  
 Drafted: D.Pratt  
 Authorised: M.Graham  
 Date: August 2022

Scale @ A1: H1:100 V1:50  
 Drawing No. 0352-07-R10  
 Sheet 10 of 16  
 Rev 1

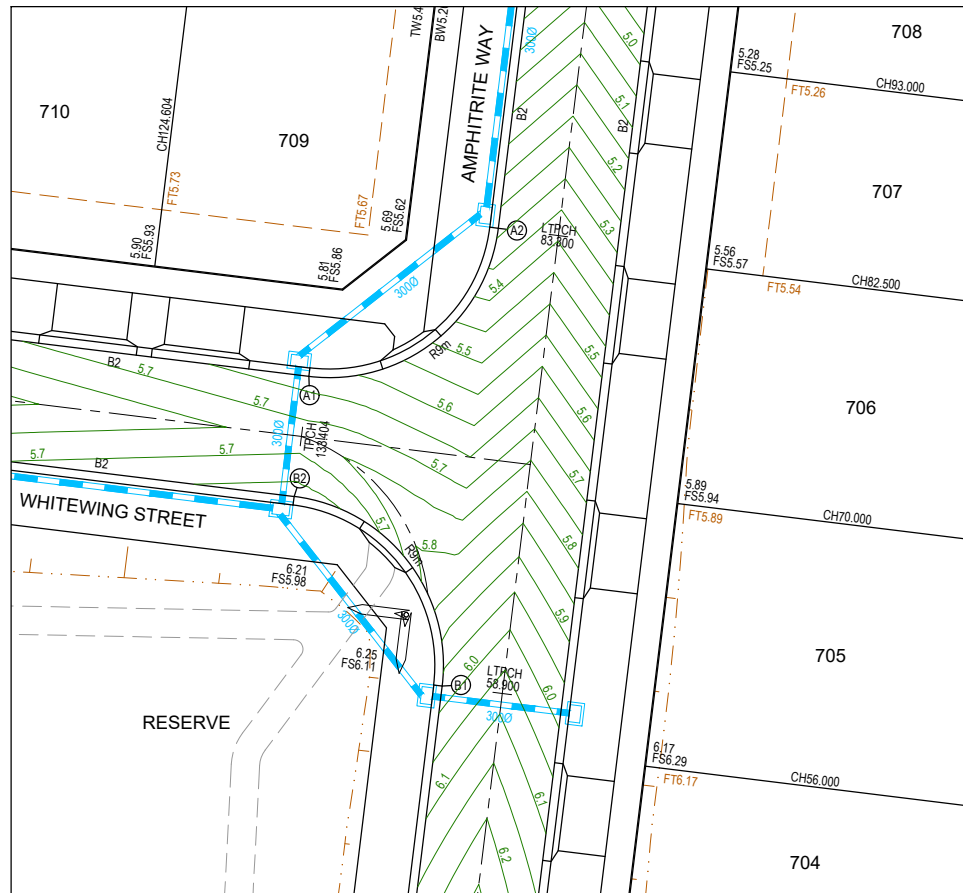

**ALIGNMENT A**

POINT NO	EASTING	NORTHING	RL
A1	270474.177	5765954.018	5.623
A2	270484.205	5765961.856	5.284

**ALIGNMENT B**

POINT NO	EASTING	NORTHING	RL
B1	270481.236	5765937.637	5.970
B2	270473.398	5765947.666	5.623

**CURVE DATA**

CURVE NO	RADIUS	CHORD	MID ORD	QTR ORD	MID ORD RL
A1 - A2	9.000	12.728	2.636	2.055	5.496
B1 - B2	9.000	12.728	2.636	2.055	5.760

**WARNING**  
**BEWARE OF UNDERGROUND SERVICES**  
 The locations of underground services are approximate only and their exact position should be proven on site.  
 No guarantee is given that all existing services are shown.  
 Locate all underground services before commencement of works.  
**DIAL 1100 BEFORE YOU DIG**  
 www.1100.com.au

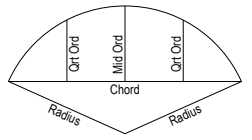

SETOUT DETAIL

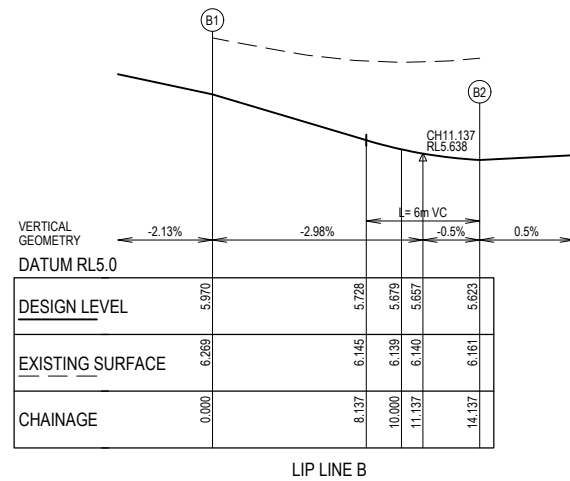
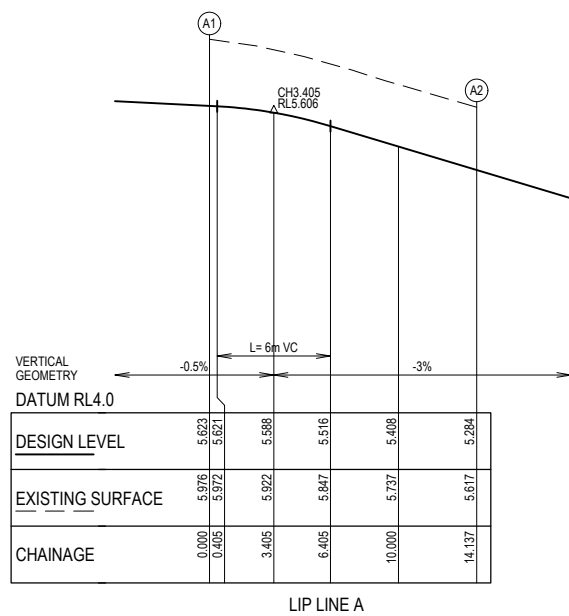

Rev	Amendment	Des/Dt	App'd	Date
A	Initial Issue	GP/DP	MG	19/08/22
1	Approved for construction	GP/DP	MG	28/10/22

Legend	
Existing Drainage	— H — Ex D —
Existing Sewer	— S — Ex S —
Existing Gas	— G — Ex G —
Existing Electricity U/G	— E — Ex E —
Existing Electricity O/H	— OH E —
Existing Communications	— T — Ex T —
Existing Drinking Water	— DW — Ex DW —
Existing Non Drinking Water	— NDW — Ex NDW —
Pavement Treatment	Concrete Infill

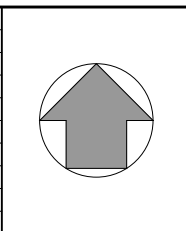

Principal  
  
 Jinding Australia  
 Level 53, 525 Collins Street  
 Melbourne Vic 3000

**GPR Consulting**  
 GPR Consulting Pty Ltd  
 ABN 98 140 136 205  
 Suite 217, 202 Jells Road  
 Wheelers Hill Vic 3150  
 Telephone 0456 634 727  
 © GPR Consulting Pty Ltd

Council	City of Greater Geelong
Project	Harriott at Armstrong Creek Stage 7
Title	Intersection Details
Designed:	G.Pratt
Drafted:	D.Pratt
Authorised:	M.Graham
Date:	August 2022

Scale @ A1:	H1:200 V1:20
Drawing No.	0352-07-R11
Sheet	11 of 16
Rev	1

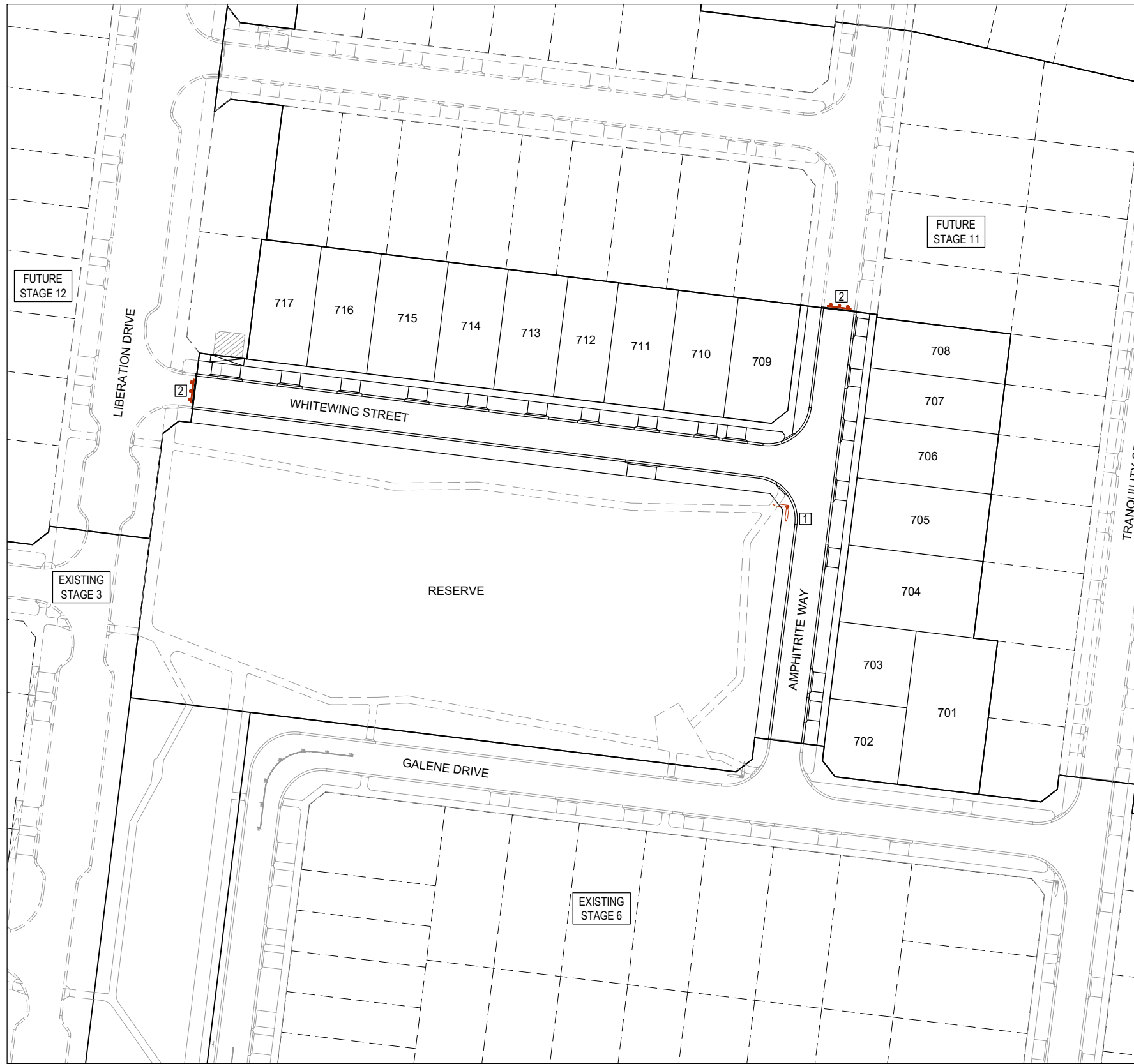

SIGN SCHEDULE		
SIGN	REF	QUANTITY
	1	REFER TABLE
G5 SERIES STREET SIGN		
	2	2
G9-20 & D4-5		

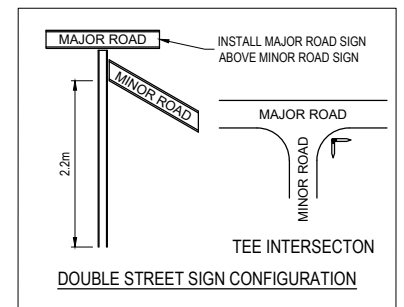

STREET SIGN SCHEDULE	
	QUANTITY
AMPHITRITE WAY	1
WHITEWING ST	1

**WARNING**  
**BEWARE OF UNDERGROUND SERVICES**  
 The locations of underground services are approximate only and their exact position should be proven on site.  
 No guarantee is given that all existing services are shown. Locate all underground services before commencement of works.  
**DIAL 1100 BEFORE YOU DIG**  
 www.1100.com.au

Rev	Amendment	Des/Dft	App'd	Date	Legend
A	Initial Issue	GP/DP	MG	19/08/22	Street Sign
1	Approved for construction	GP/DP	MG	28/10/22	Sign RRPM

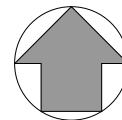

Principal  
  
**HARRIOTT**  
 AT ARMSTRONG CREEK  
 Jinding Australia  
 Level 53, 525 Collins Street  
 Melbourne Vic 3000

**GPR Consulting**  
 GPR Consulting Pty Ltd  
 ABN 98 140 136 205  
 Suite 217, 202 Jells Road  
 Wheelers Hill Vic 3150  
 Telephone 0456 634 727  
 © GPR Consulting Pty Ltd

Council City of Greater Geelong  
 Project **Harriott at Armstrong Creek Stage 7**  
 Title Signage & Linemarking Plan  
 Designed: G.Pratt  
 Drafted: D.Pratt  
 Authorised: M.Graham  
 Date: August 2022

Scale @ A1: 1:500  
  
 Drawing No. **0352-07-R12**  
 Sheet 12 of 16  
 Rev **1**

**NOTE: STORMWATER PIPES**

- ALL STORMWATER PIPES ARE TO BE CLASS 2 WITH RUBBER RINGED JOINTS UNLESS NOTED OTHERWISE.
- STORMWATER PIPES UNDER ROAD PAVEMENTS, DRIVEWAYS, FOOTPATHS, PARKING BAYS AND BEHIND KERB AND CHANNEL TO BE BACKFILLED WITH 20MM CLASS 3 FINE CRUSHED ROCK (WETMIX) COMPACTED TO 98% MODIFIED IN MAXIMUM 150MM LAYERS.
- STORMWATER PIPES UNDER ROADS ARE TO HAVE 2% STABILISED SAND EMBEDMENT TO SPRINGLINE.

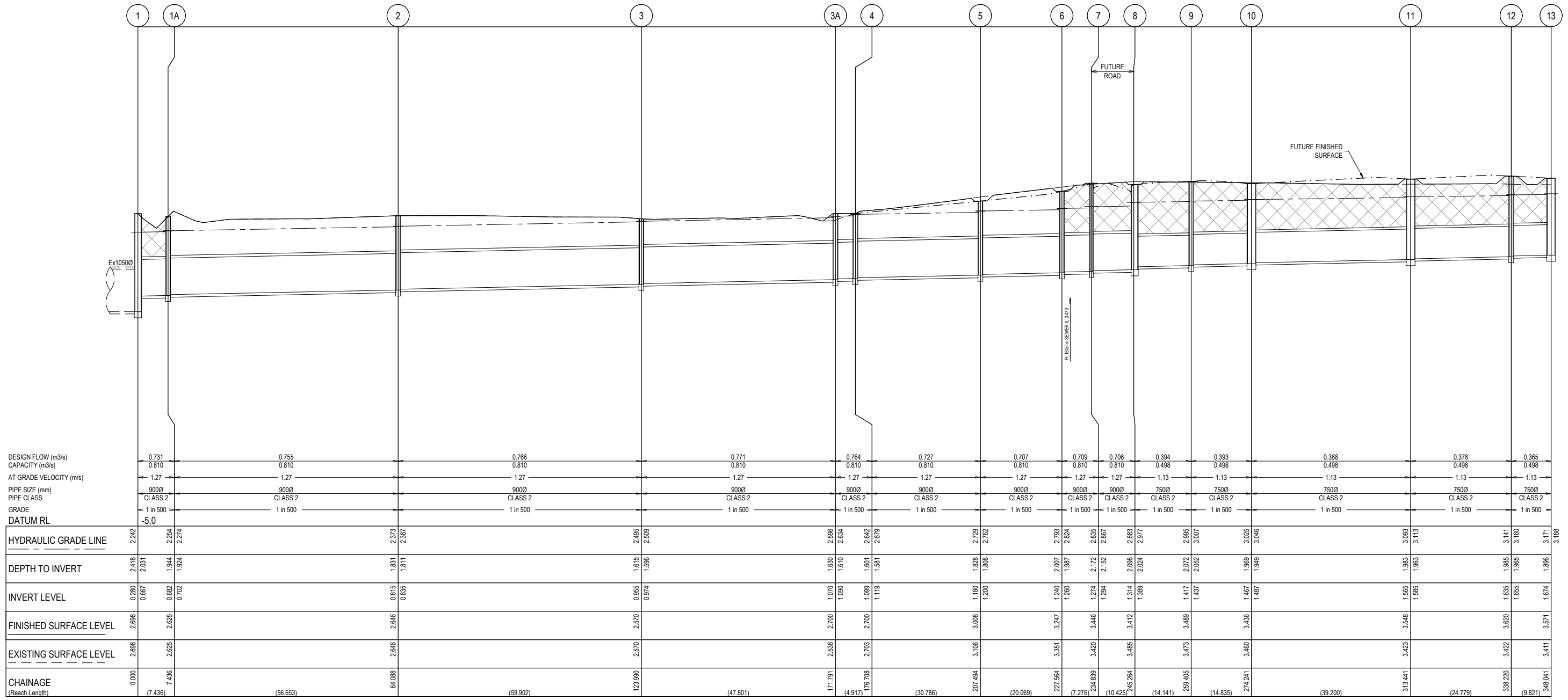

Rev	Amendment	Des/Dt	App'd	Date	Legend
A	Initial Issue	GP/DP	MG	19/08/22	Existing Surface
B	Drain 1 to 4 and HGL amended	GP/DP	MG	11/10/22	Design Surface
1	Approved for construction	GP/DP	MG	28/10/22	Future Design Surface
					Existing Drain
					Proposed Drain
					Hydraulic Grade Line
					Retaining Wall
					Crushed Rock Backfill
					Rock Beaching

Chainage (Reach Length)	Hydraulic Grade Line	Depth to Invert	Invert Level	Finished Surface Level	Existing Surface Level
0.000 (7.436)	2.242	2.418	2.280	2.698	2.698
64.088 (56.653)	2.373	1.831	0.815	2.646	2.646
123.990 (59.902)	2.595	1.615	0.955	2.570	2.570
171.791 (47.801)	2.596	1.630	1.070	2.700	2.538
207.494 (30.786)	2.729	1.828	1.180	3.008	3.106
227.564 (20.069)	2.783	2.007	1.240	3.247	3.351
234.839 (7.276)	2.867	2.152	1.294	3.446	3.420
245.264 (10.425)	2.977	2.024	1.389	3.412	3.485
259.405 (14.141)	3.007	2.072	1.417	3.489	3.473
274.241 (14.835)	3.046	1.949	1.467	3.436	3.460
313.441 (39.200)	3.113	1.963	1.585	3.548	3.423
338.220 (24.779)	3.160	1.965	1.635	3.620	3.422
346.041 (9.821)	3.171	1.896	1.674	3.571	3.411

Principal  
 HARRIOTT  
 AT ARMSTRONG CREEK  
 Jinding Australia  
 Level 53, 525 Collins Street  
 Melbourne Vic 3000

**GPR Consulting**  
 GPR Consulting Pty Ltd  
 ABN 98 140 136 205  
 Suite 217, 202 Jells Road  
 Wheelers Hill Vic 3150  
 Telephone 0456 634 727  
 © GPR Consulting Pty Ltd

Council City of Greater Geelong  
 Project **Harriott at Armstrong Creek Stage 7**  
 Title Drainage Longitudinal Sections Sheet 1 of 3  
 Designed: G.Pratt  
 Drafted: D.Pratt  
 Authorised: M.Graham  
 Date: August 2022

Scale @ A1: H1:500 V1:50  
  
 Drawing No. **0352-07-R13**  
 Sheet 13 of 16  
 Rev **1**

**NOTE: STORMWATER PIPES**

1. ALL STORMWATER PIPES ARE TO BE CLASS 2 WITH RUBBER RINGED JOINTS UNLESS NOTED OTHERWISE.
2. STORMWATER PIPES UNDER ROAD PAVEMENTS, DRIVEWAYS, FOOTPATHS, PARKING BAYS AND BEHIND KERB AND CHANNEL TO BE BACKFILLED WITH 20MM CLASS 3 FINE CRUSHED ROCK (WETMIX) COMPACTED TO 98% MODIFIED IN MAXIMUM 150MM LAYERS.
3. STORMWATER PIPES UNDER ROADS ARE TO HAVE 2% STABILISED SAND EMBEDMENT TO SPRINGLINE.

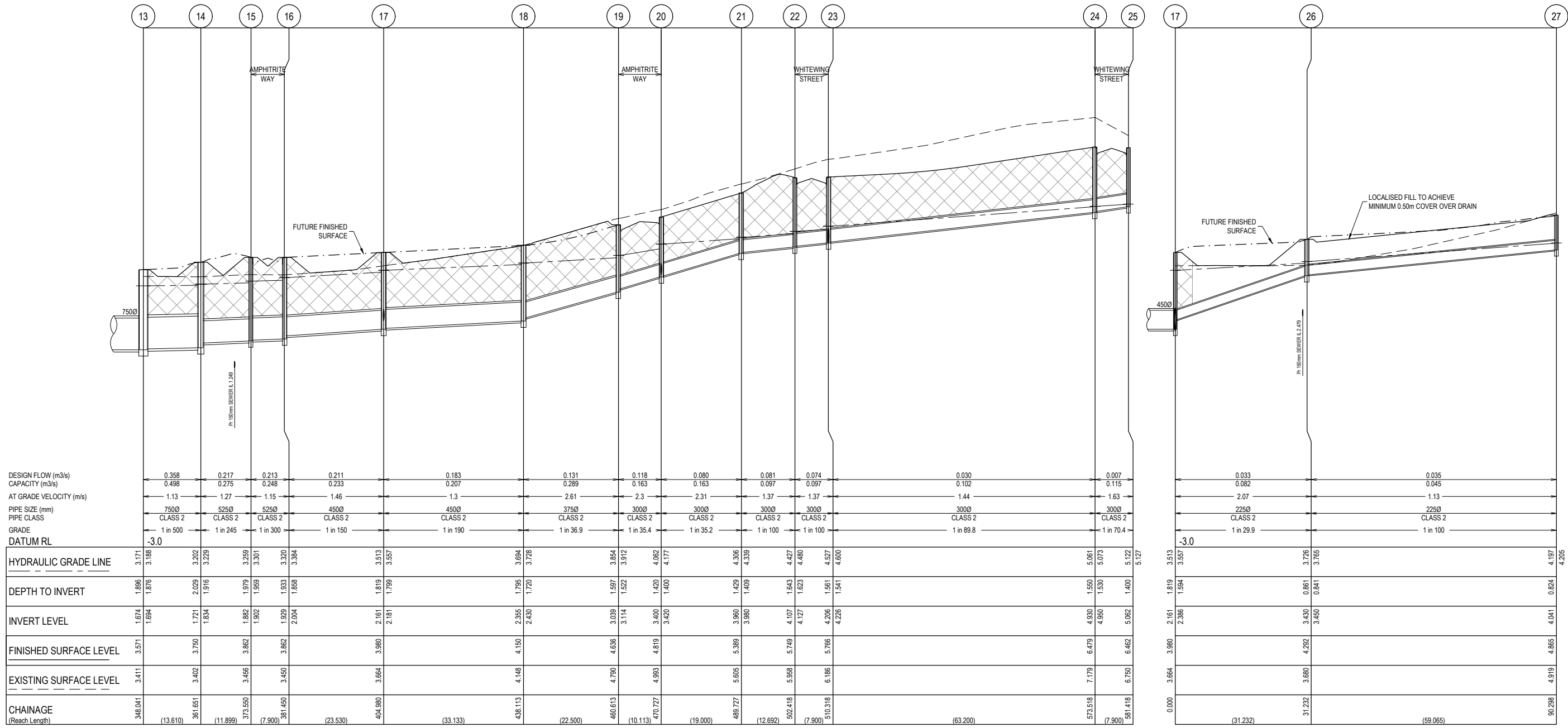

Rev	Amendment	Des/Dt	App'd	Date	Legend
A	Initial Issue	GP/DP	MG	19/08/22	Existing Surface
B	HGL amended	GP/DP	MG	11/10/22	Design Surface
1	Approved for construction	GP/DP	MG	28/10/22	Future Design Surface

Existing Drain	Proposed Drain	Hydraulic Grade Line	Retaining Wall	Crushed Rock Backfill	Rock Beaching
----------------	----------------	----------------------	----------------	-----------------------	---------------

Principal  
 HARRIOTT  
 AT ARMSTRONG CREEK  
 Jinding Australia  
 Level 53, 525 Collins Street  
 Melbourne Vic 3000

**GPR Consulting**  
 GPR Consulting Pty Ltd  
 ABN 98 140 136 205  
 Suite 217, 202 Jells Road  
 Wheelers Hill Vic 3150  
 Telephone 0456 634 727  
 © GPR Consulting Pty Ltd

Council City of Greater Geelong  
 Project Harriott at Armstrong Creek Stage 7  
 Title Drainage Longitudinal Sections Sheet 2 of 3  
 Designed: G.Pratt  
 Drafted: D.Pratt  
 Authorised: M.Graham  
 Date: August 2022

Scale @ A1: H1:500 V1:50  
  
 Drawing No. 0352-07-R14  
 Sheet 14 of 16  
 Rev 1

**NOTE: STORMWATER PIPES**

1. ALL STORMWATER PIPES ARE TO BE CLASS 2 WITH RUBBER RINGED JOINTS UNLESS NOTED OTHERWISE.
2. STORMWATER PIPES UNDER ROAD PAVEMENTS, DRIVEWAYS, FOOTPATHS, PARKING BAYS AND BEHIND KERB AND CHANNEL TO BE BACKFILLED WITH 20MM CLASS 3 FINE CRUSHED ROCK (WETMIX) COMPACTED TO 98% MODIFIED IN MAXIMUM 150MM LAYERS.
3. STORMWATER PIPES UNDER ROADS ARE TO HAVE 2% STABILISED SAND EMBEDMENT TO SPRINGLINE.

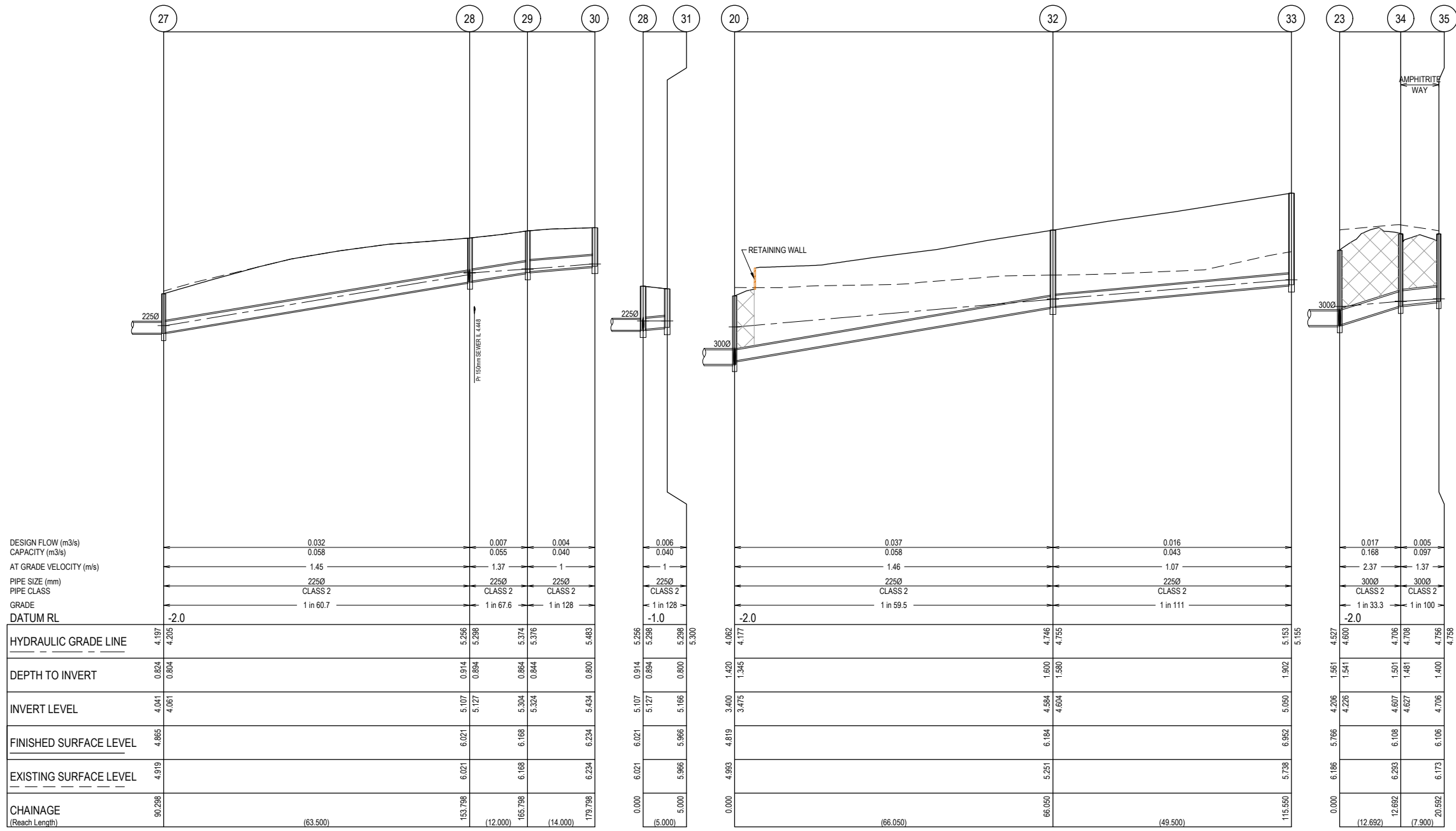

Rev	Amendment	Des/Dt	App'd	Date	Legend
A	Initial Issue	GP/DP	MG	19/08/22	Existing Surface - - - -
B	HGL amended	GP/DP	MG	11/10/22	Design Surface - - - -
1	Approved for construction	GP/DP	MG	28/10/22	Future Design Surface - - - -
					Existing Drain - - - -
					Proposed Drain - - - -
					Hydraulic Grade Line - - - -
					Retaining Wall - - - -
					Crushed Rock Backfill - - - -
					Rock Beaching - - - -

HYDRAULIC GRADE LINE	DEPTH TO INVERT	INVERT LEVEL	FINISHED SURFACE LEVEL	EXISTING SURFACE LEVEL	CHAINAGE (Reach Length)
4.197	0.824	4.041	4.865	4.919	90.298
4.205	0.804	4.061			(63.500)
5.256	0.914	5.107	6.021	6.021	153.798
5.288	0.894	5.127			(12.000)
5.374	0.864	5.304	6.168	6.168	165.798
5.376	0.844	5.324			(14.000)
5.453	0.800	5.454	6.234	6.234	179.798
5.483					(5.000)
5.256	0.914	5.107	6.021	6.021	0.000
5.288	0.894	5.127			(5.000)
5.374	0.864	5.304	6.168	6.168	0.000
5.376	0.844	5.324			(66.050)
5.453	0.800	5.454	6.234	6.234	66.050
5.483					(49.500)
4.062	1.420	3.400	4.819	4.993	0.000
4.177	1.345	3.475			(5.000)
4.746	1.600	4.584	6.184	5.251	66.050
4.755	1.580	4.604			(49.500)
5.153	1.902	5.050	6.962	5.738	115.550
5.165					(12.692)
4.527	1.561	4.206	5.766	6.186	0.000
4.600	1.541	4.226			(12.692)
4.706	1.501	4.607	6.108	6.293	12.692
4.708	1.481	4.627			(7.900)
4.756	1.400	4.706	6.106	6.173	20.592
4.758					(7.900)

Principal  
  
 Jinding Australia  
 Level 53, 525 Collins Street  
 Melbourne Vic 3000

**GPR Consulting**  
 GPR Consulting Pty Ltd  
 ABN 98 140 136 205  
 Suite 217, 202 Jells Road  
 Wheelers Hill Vic 3150  
 Telephone 0456 634 727  
 © GPR Consulting Pty Ltd

Council City of Greater Geelong  
 Project **Harriott at Armstrong Creek Stage 7**  
 Title Drainage Longitudinal Sections Sheet 3 of 3  
 Designed: G.Pratt  
 Drafted: D.Pratt  
 Authorised: M.Graham  
 Date: August 2022

Scale @ A1: H1:500 V1:50  
  
 Drawing No. **0352-07-R15**  
 Sheet 15 of 16  
 Rev **1**

PIT SCHEDULE													
PIT No.	TYPE	LOCATION		INTERNAL		INLET		OUTLET		COVER LEVEL	PIT DEPTH	STD DWG	REMARKS
		EASTING	NORTHING	WIDTH	LENGTH	DIA.	INV R.L.	DIA.	INV R.L.				
1	JUNCTION PIT	270208.947	5766179.200	1500	1800	900	0.667	1050	0.280	2.698	2.418	SD 410 & SD 420	REMOVE EXISTING PIT AND CONSTRUCT NEW PIT OVER EXISTING DRAINS. HAUNCH PIT TO 600X900 CLASS D COVER
1A	GRATED PIT	270215.565	5766175.983	1350	900	900	0.702	900	0.682	2.625	1.944	SD 410 & SD 425	HAUNCH PIT TO 600X900 GRATE COVER
2	GRATED PIT	270271.800	5766169.137	1200	900	900	0.835	900	0.815	2.646	1.831	SD 410 & SD 425	HAUNCH PIT TO 600X900 GRATE COVER
3	GRATED PIT	270331.425	5766174.845	1200	900	900	0.974	900	0.955	2.570	1.615	SD 410 & SD 425	HAUNCH PIT TO 600X900 GRATE COVER
3A	GRATED PIT	270378.819	5766168.928	1350	900	900	1.090	900	1.070	2.700	1.630	SD 410 & SD 425	HAUNCH PIT TO 600X900 GRATE COVER
4	GRATED PIT	270381.805	5766165.107	1350	900	900	1.119	900	1.099	2.700	1.601	SD 410 & SD 425	HAUNCH PIT TO 600X900 CLASS D GRATE COVER
5	GRATED PIT	270378.233	5766134.563	1200	900	900	1.200	900	1.180	3.008	1.828	SD 410 & SD 425	HAUNCH PIT TO 600X900 CLASS D GRATE COVER
6	JUNCTION PIT	270375.790	5766114.643	1200	900	900	1.260	900	1.240	3.247	2.007	SD 410 & SD 425	HAUNCH PIT TO 600X900 CLASS D COVER
7	FUTURE DOUBLE SIDE ENTRY PIT	270374.636	5766107.470	600	1900	900	1.294	900	1.274	3.446	2.172	SD 445	PROVIDE JUNCTION PIT COVER
8	FUTURE DOUBLE SIDE ENTRY PIT	270375.610	5766097.091	1050	1900	750	1.389	900	1.314	3.412	2.098	SD 410 & SD 445	HAUNCH PIT TO 2X600X900 JUNCTION PIT COVERS
9	JUNCTION PIT	270389.746	5766097.216	1050	900	750	1.437	750	1.417	3.489	2.072	SD 410 & SD 425	HAUNCH PIT TO 600X900 COVER
10	FUTURE DOUBLE SIDE ENTRY PIT	270404.384	5766094.826	1050	1900	750	1.487	750	1.467	3.436	1.969	SD 410 & SD 445	HAUNCH PIT TO 2X600X900 JUNCTION PIT COVERS
11	FUTURE DOUBLE SIDE ENTRY PIT	270442.627	5766086.218	1050	1900	750	1.585	750	1.565	3.548	1.983	SD 410 & SD 445	HAUNCH PIT TO 2X600X900 JUNCTION PIT COVERS
12	JUNCTION PIT	270466.802	5766080.776	1050	900	750	1.655	750	1.635	3.620	1.985	SD 410 & SD 420	HAUNCH PIT TO 600X900 COVER
13	FUTURE DOUBLE SIDE ENTRY PIT	270476.383	5766078.620	1050	1900	750	1.694	750	1.674	3.571	1.896	SD 410 & SD 445	HAUNCH PIT TO 2X600X900 JUNCTION PIT COVERS
14	JUNCTION PIT	270489.661	5766075.631	1050	1200	525	1.834	750	1.721	3.750	2.029	SD 410 & SD 420	HAUNCH PIT TO 600X900 COVER
15	FUTURE SIDE ENTRY PIT	270496.224	5766066.031	600	1050	525	1.902	525	1.882	3.862	1.979	SD 410 & SD 430	HAUNCH PIT TO 600X900 JUNCTION PIT COVER
16	FUTURE SIDE ENTRY PIT	270504.065	5766065.070	600	900	450	2.004	525	1.929	3.862	1.933	SD 430	PROVIDE JUNCTION PIT COVER
17	JUNCTION PIT	270501.201	5766041.714	600	900	450	2.181	450	2.161	3.980	1.819	SD 420	
18	FUTURE SIDE ENTRY PIT	270497.168	5766008.827	600	900	375	2.430	450	2.355	4.150	1.795	SD 430	PROVIDE JUNCTION PIT COVER
19	FUTURE SIDE ENTRY PIT	270494.430	5765986.495	600	900	300	3.114	375	3.039	4.636	1.597	SD 430	PROVIDE JUNCTION PIT COVER
20	SIDE ENTRY PIT	270485.846	5765981.402	600	900	300	3.420	300	3.400	4.819	1.420	SD 430	
21	JUNCTION PIT	270483.534	5765962.543	600	900	300	3.980	300	3.960	5.389	1.429	SD 420	
22	SIDE ENTRY PIT	270473.673	5765954.836	600	900	300	4.127	300	4.107	5.749	1.643	SD 430	
23	SIDE ENTRY PIT	270472.711	5765946.994	600	900	300	4.226	300	4.206	5.766	1.561	SD 430	
24	SIDE ENTRY PIT	270409.981	5765954.686	600	900	300	4.950	300	4.930	6.479	1.550	SD 430	
25	SIDE ENTRY PIT	270410.942	5765962.528	600	900			300	5.062	6.462	1.400	SD 430	
26	JUNCTION PIT	270531.676	5766034.885	600	900	225	3.454	225	3.434	4.292	0.857	SD 425	
27	JUNCTION PIT	270524.458	5765976.264	600	900	225	4.065	225	4.045	4.865	0.820	SD 425	
28	JUNCTION PIT	270516.730	5765913.236	600	900	225	5.127	225	5.107	6.021	0.914	SD 425	
29	JUNCTION PIT	270504.819	5765914.697	600	900	225	5.324	225	5.304	6.168	0.864	SD 425	
30	JUNCTION PIT	270503.115	5765900.801	600	900			225	5.434	6.234	0.800	SD 425	
31	JUNCTION PIT	270521.693	5765912.628	600	900			225	5.166	5.966	0.800	SD 425	
32	JUNCTION PIT	270420.287	5765989.440	600	900	225	4.604	225	4.584	6.184	1.600	SD 425	
33	JUNCTION PIT	270371.155	5765995.465	600	900			225	5.050	6.952	1.902	SD 425	
34	SIDE ENTRY PIT	270480.418	5765937.133	600	900	300	4.627	300	4.607	6.108	1.501	SD 430	
35	SIDE ENTRY PIT	270488.260	5765936.172	600	900			300	4.706	6.106	1.400	SD 430	

NOTE:  
1. PIT COVERS ARE TO PROVIDED IN ACCORDANCE WITH CITY OF GREATER GEELONG DESIGN NOTE No. 13.  
2. ALL PIT COVERS IN THE ROAD RESERVE ARE TO BE CLASS C FIBREGLASS REINFORCED PLASTIC (FRP) UNLESS NOTED OTHERWISE.

Rev	Amendment	Des/Dr	App'd	Date
A	Initial Issue	GP/DP	MG	19/08/22
B	Pits 1 to 4 amended and 1A & 3A added	GP/DP	MG	11/10/22
1	Approved for construction	GP/DP	MG	28/10/22

Principal



**HARRIOTT**  
AT ARMSTRONG CREEK

Jinding Australia  
Level 53, 525 Collins Street  
Melbourne Vic 3000



GPR Consulting Pty Ltd  
ABN 98 140 136 205  
Suite 217, 202 Jells Road  
Wheeters Hill Vic 3150  
Telephone 0456 634 727  
© GPR Consulting Pty Ltd

Council	City of Greater Geelong	Scale @ A1:
Project	<b>Harriott at Armstrong Creek Stage 7</b>	
Title	Pit Schedule	Drawing No. <b>0352-07-R16</b>
Designed:	G.Pratt	Authorised: M.Graham
Drafted:	D.Pratt	Date: August 2022
Sheet	16 of 16	Rev <b>1</b>