

# SCHEDULE 1

## HARRIOTT @ ARMSTRONG CREEK STAGE 8B BUILDING ENVELOPES

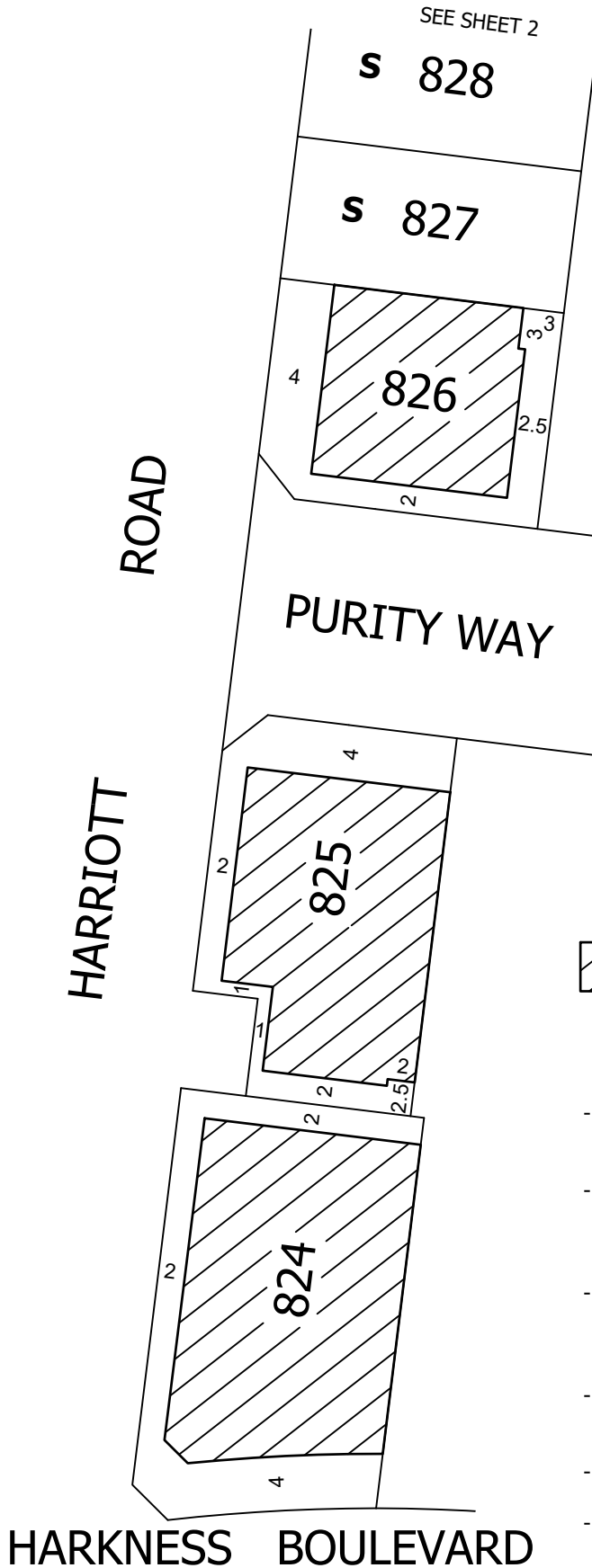

- BUILDING ENVELOPE

**S**

- SMALL LOT HOUSING CODE - TYPE A

- Garages are to be set back a minimum of 5 metres from the primary frontage of the allotment and 0.50 metres behind the front of the dwelling
- Balconies, verandas, open porches, covered walkways and porticos that have a maximum height less than 4.50 metres above the ground level may encroach into the front setback by 1.50 metres.
- Facade treatments and /or covered balconies or verandas on the second storey of a building that have a maximum height of less than 6.60 metres above ground level may encroach into the front setback by 1.50 metres.
- Porches, verandas, eaves, fascia, gutters and screens may encroach into the side and rear setback by 0.50 metres
- Domestic fuel tanks and water tanks may encroach into the side and rear setback by 0.50 metres
- Heating and cooling equipment and other services may encroach into the side and rear setback by 0.50 metres



MC MULLEN NOLAN GROUP  
31/574 Plummer Street,  
Port Melbourne, VIC, 3207  
Tel: (03) 7002 2200  
Fax: (03) 7002 2299  
www.mngsurvey.com.au  
MNG Ref : 80004be-072a

SCALE  
1:500

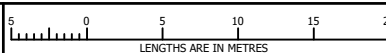

ORIGINAL SHEET  
SIZE: A4

SHEET 1 OF 5

VERSION A



# SCHEDULE 1

## HARRIOTT @ ARMSTRONG CREEK STAGE 8B BUILDING ENVELOPES

SEE SHEET 3

DARTER WAY

S 834

S 833

S 832

S 831

S 830

HARRIOTT ROAD

LAPIS STREET

829

S 828

827

SEE SHEET 1



- BUILDING ENVELOPE

**S**

- SMALL LOT HOUSING CODE - TYPE A

- Garages are to be set back a minimum of 5 metres from the primary frontage of the allotment and 0.50 metres behind the front of the dwelling
- Balconies, verandas, open porches, covered walkways and porticos that have a maximum height less than 4.50 metres above the ground level may encroach into the front setback by 1.50 metres.
- Facade treatments and /or covered balconies or verandas on the second storey of a building that have a maximum height of less than 6.60 metres above ground level may encroach into the front setback by 1.50 metres.
- Porches, verandas, eaves, fascia, gutters and screens may encroach into the side and rear setback by 0.50 metres
- Domestic fuel tanks and water tanks may encroach into the side and rear setback by 0.50 metres
- Heating and cooling equipment and other services may encroach into the side and rear setback by 0.50 metres

M.G.A. 2020 |  
ZONE 55 |

SCALE  
1:500

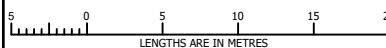

ORIGINAL SHEET  
SIZE: A4

SHEET 2



MC MULLEN NOLAN GROUP  
31/574 Plummer Street,  
Port Melbourne, VIC, 3207  
Tel: (03) 7002 2200  
Fax: (03) 7002 2299  
www.mngsurvey.com.au  
MNG Ref : 80004be-072a

VERSION A

HARRIOTT  
AT ARMSTRONG CREEK

# SCHEDULE 1

## HARRIOTT @ ARMSTRONG CREEK STAGE 8B BUILDING ENVELOPES

SEE SHEET 4

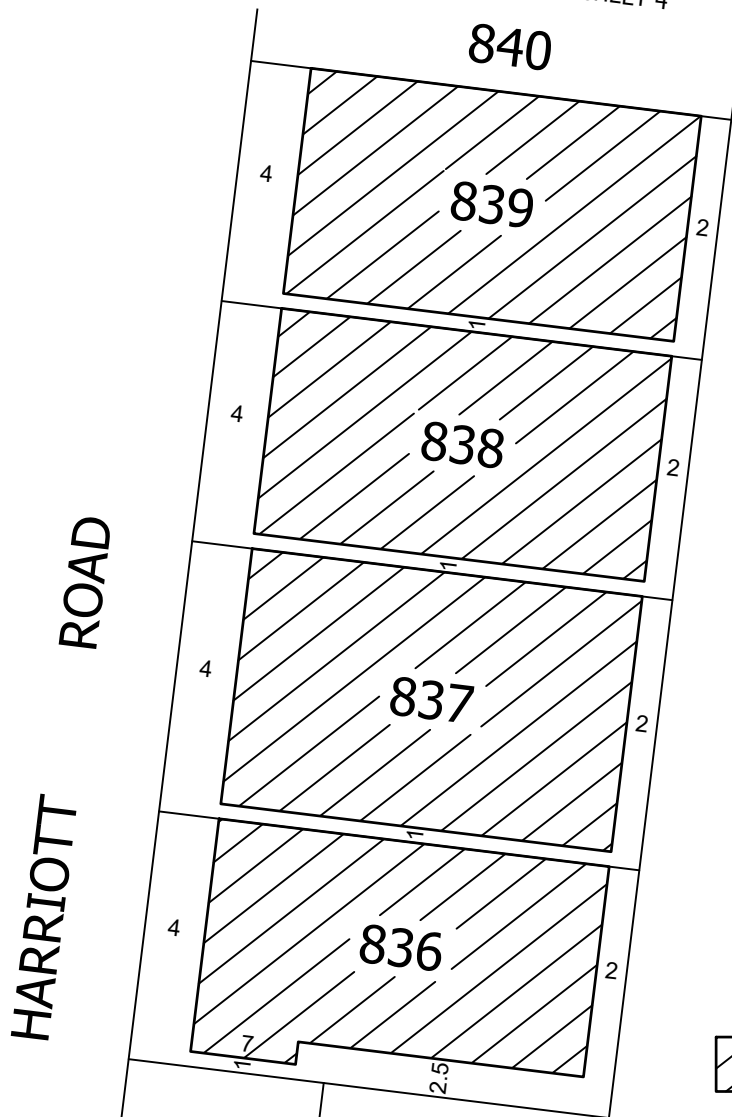

HARRIOTT ROAD



- BUILDING ENVELOPE

**S**

- SMALL LOT HOUSING CODE - TYPE A

**S** 835

DARTER WAY

834

SEE SHEET 2

- Garages are to be set back a minimum of 5 metres from the primary frontage of the allotment and 0.50 metres behind the front of the dwelling
- Balconies, verandas, open porches, covered walkways and porticos that have a maximum height less than 4.50 metres above the ground level may encroach into the front setback by 1.50 metres.
- Facade treatments and /or covered balconies or verandas on the second storey of a building that have a maximum height of less than 6.60 metres above ground level may encroach into the front setback by 1.50 metres.
- Porches, verandas, eaves, fascia, gutters and screens may encroach into the side and rear setback by 0.50 metres
- Domestic fuel tanks and water tanks may encroach into the side and rear setback by 0.50 metres
- Heating and cooling equipment and other services may encroach into the side and rear setback by 0.50 metres

SCALE  
1:500

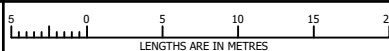

ORIGINAL SHEET  
SIZE: A4

SHEET 3



MC MULLEN NOLAN GROUP  
31/574 Plummer Street,  
Port Melbourne, VIC, 3207  
Tel: (03) 7002 2200  
Fax: (03) 7002 2299  
www.mngsurvey.com.au  
MNG Ref : 80004be-072a

VERSION A



# SCHEDULE 1

## HARRIOTT @ ARMSTRONG CREEK STAGE 8B BUILDING ENVELOPES

SEE SHEET 5

844

SERENITY STREET

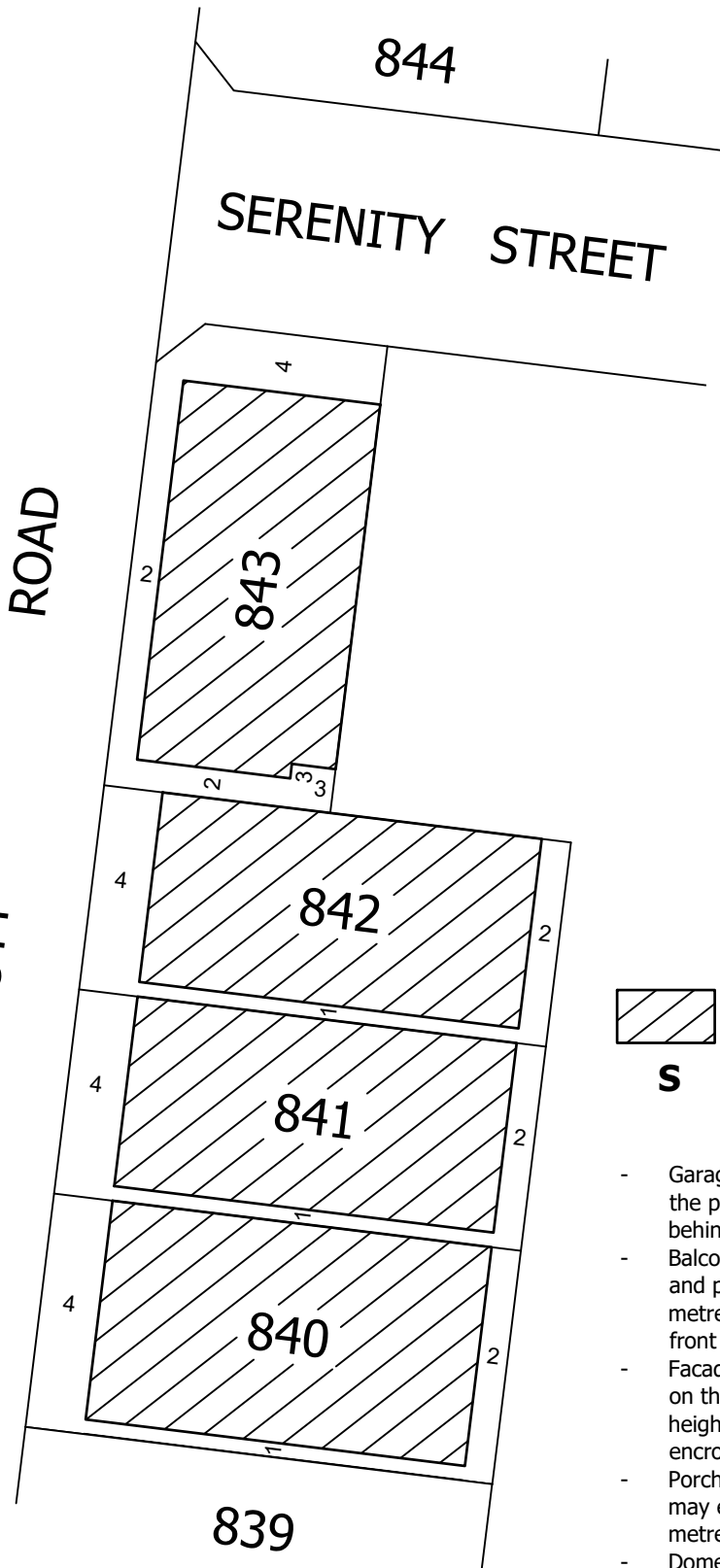

M.G.A. 2020 |  
ZONE 55 |



- BUILDING ENVELOPE

**S**

- SMALL LOT HOUSING CODE - TYPE A

- Garages are to be set back a minimum of 5 metres from the primary frontage of the allotment and 0.50 metres behind the front of the dwelling
- Balconies, verandas, open porches, covered walkways and porticos that have a maximum height less than 4.50 metres above the ground level may encroach into the front setback by 1.50 metres.
- Facade treatments and /or covered balconies or verandas on the second storey of a building that have a maximum height of less than 6.60 metres above ground level may encroach into the front setback by 1.50 metres.
- Porches, verandas, eaves, fascia, gutters and screens may encroach into the side and rear setback by 0.50 metres
- Domestic fuel tanks and water tanks may encroach into the side and rear setback by 0.50 metres
- Heating and cooling equipment and other services may encroach into the side and rear setback by 0.50 metres

SEE SHEET 3

839



MC MULLEN NOLAN GROUP  
31/574 Plummer Street,  
Port Melbourne, VIC, 3207  
Tel: (03) 7002 2200  
Fax: (03) 7002 2299  
www.mngsurvey.com.au  
MNG Ref : 80004be-072a

SCALE  
1:500

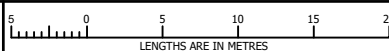

ORIGINAL SHEET  
SIZE: A4

SHEET 4

VERSION A



# SCHEDULE 1

## HARRIOTT @ ARMSTRONG CREEK STAGE 8B BUILDING ENVELOPES

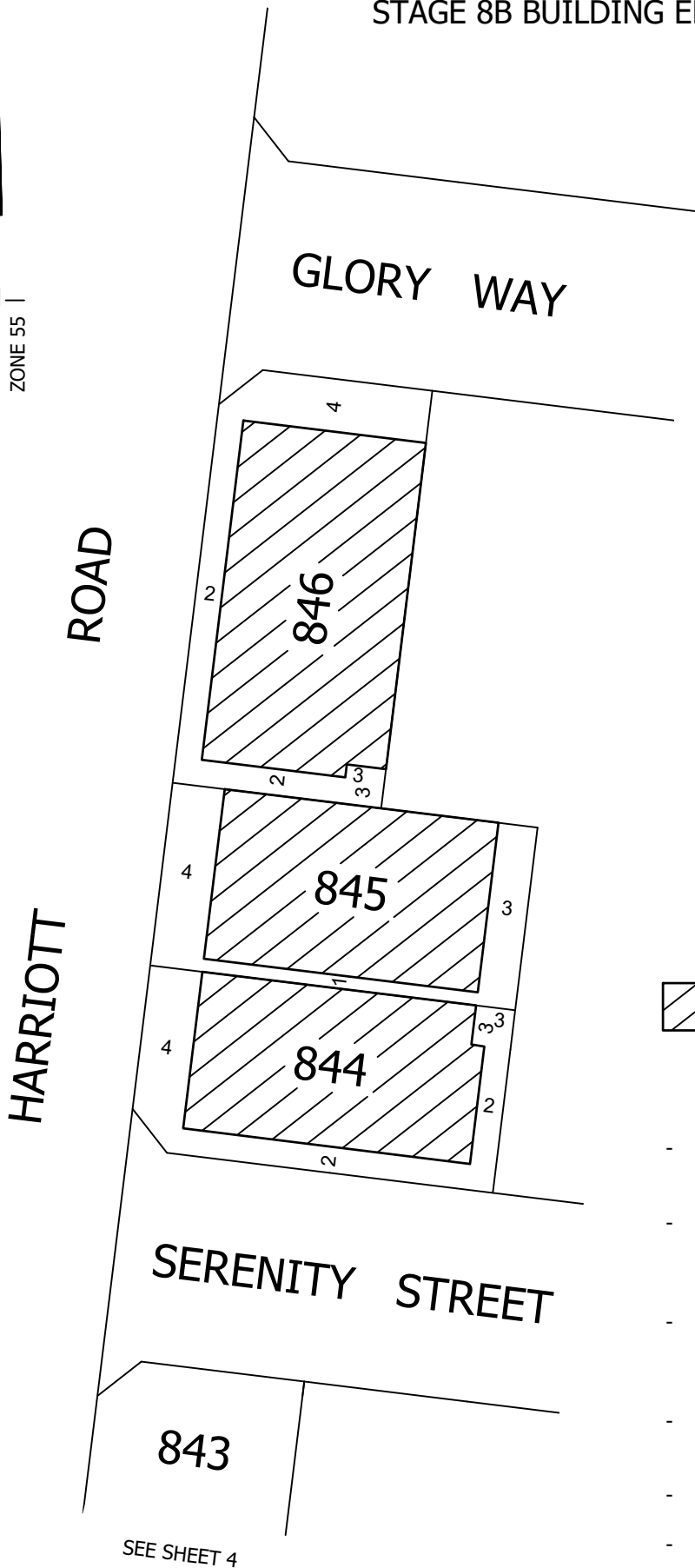

- BUILDING ENVELOPE

**S**

- SMALL LOT HOUSING CODE - TYPE A

- Garages are to be set back a minimum of 5 metres from the primary frontage of the allotment and 0.50 metres behind the front of the dwelling
- Balconies, verandas, open porches, covered walkways and porticos that have a maximum height less than 4.50 metres above the ground level may encroach into the front setback by 1.50 metres.
- Facade treatments and /or covered balconies or verandas on the second storey of a building that have a maximum height of less than 6.60 metres above ground level may encroach into the front setback by 1.50 metres.
- Porches, verandas, eaves, fascia, gutters and screens may encroach into the side and rear setback by 0.50 metres
- Domestic fuel tanks and water tanks may encroach into the side and rear setback by 0.50 metres
- Heating and cooling equipment and other services may encroach into the side and rear setback by 0.50 metres

SCALE  
1:500

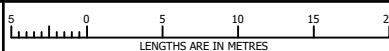

ORIGINAL SHEET  
SIZE: A4

SHEET 5



MC MULLEN NOLAN GROUP  
31/574 Plummer Street,  
Port Melbourne, VIC, 3207  
Tel: (03) 7002 2200  
Fax: (03) 7002 2299  
www.mngsurvey.com.au  
MNG Ref : 80004be-072a

VERSION A

